

## E3 - 1.2

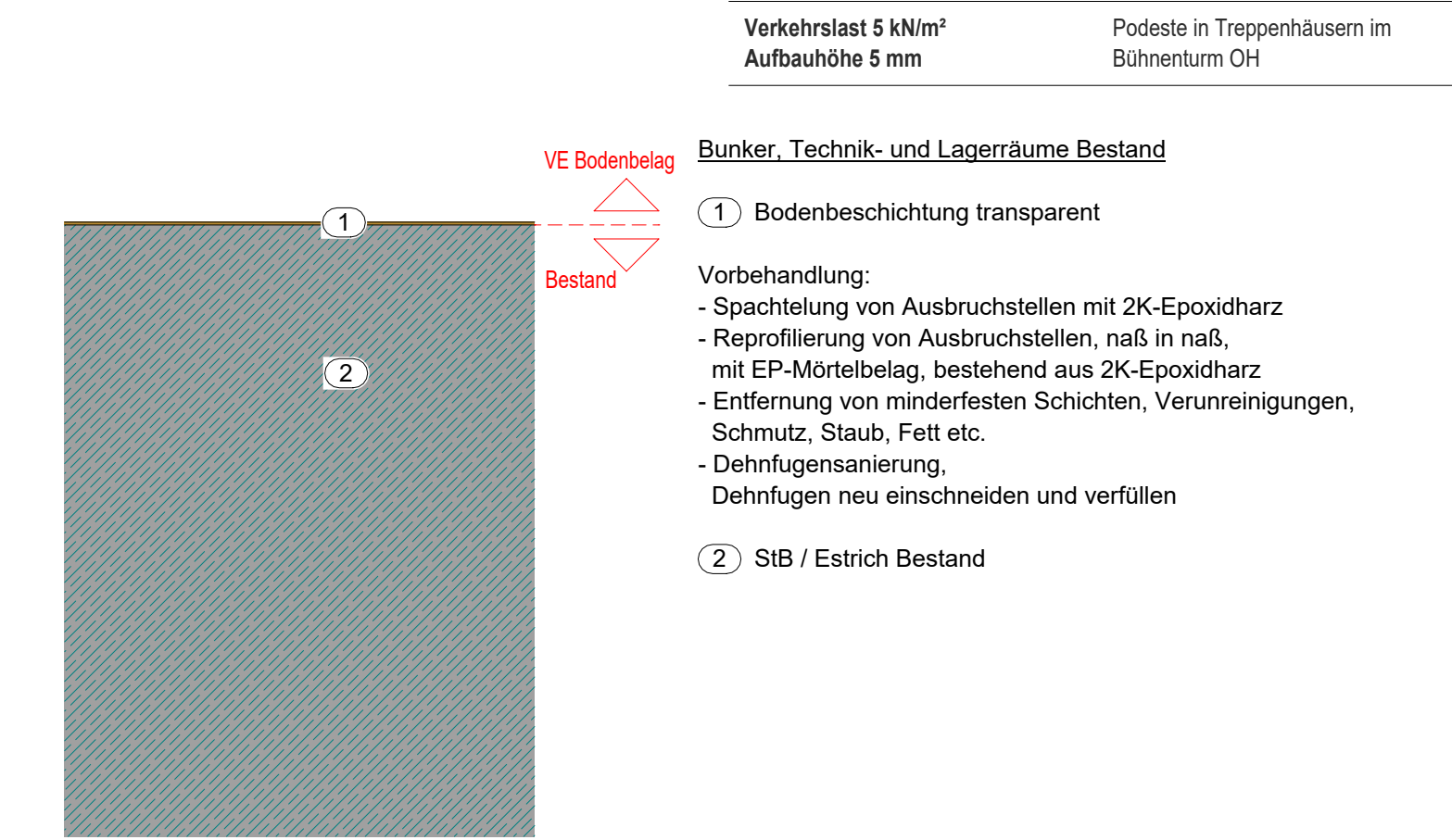

## E3 - 3.1

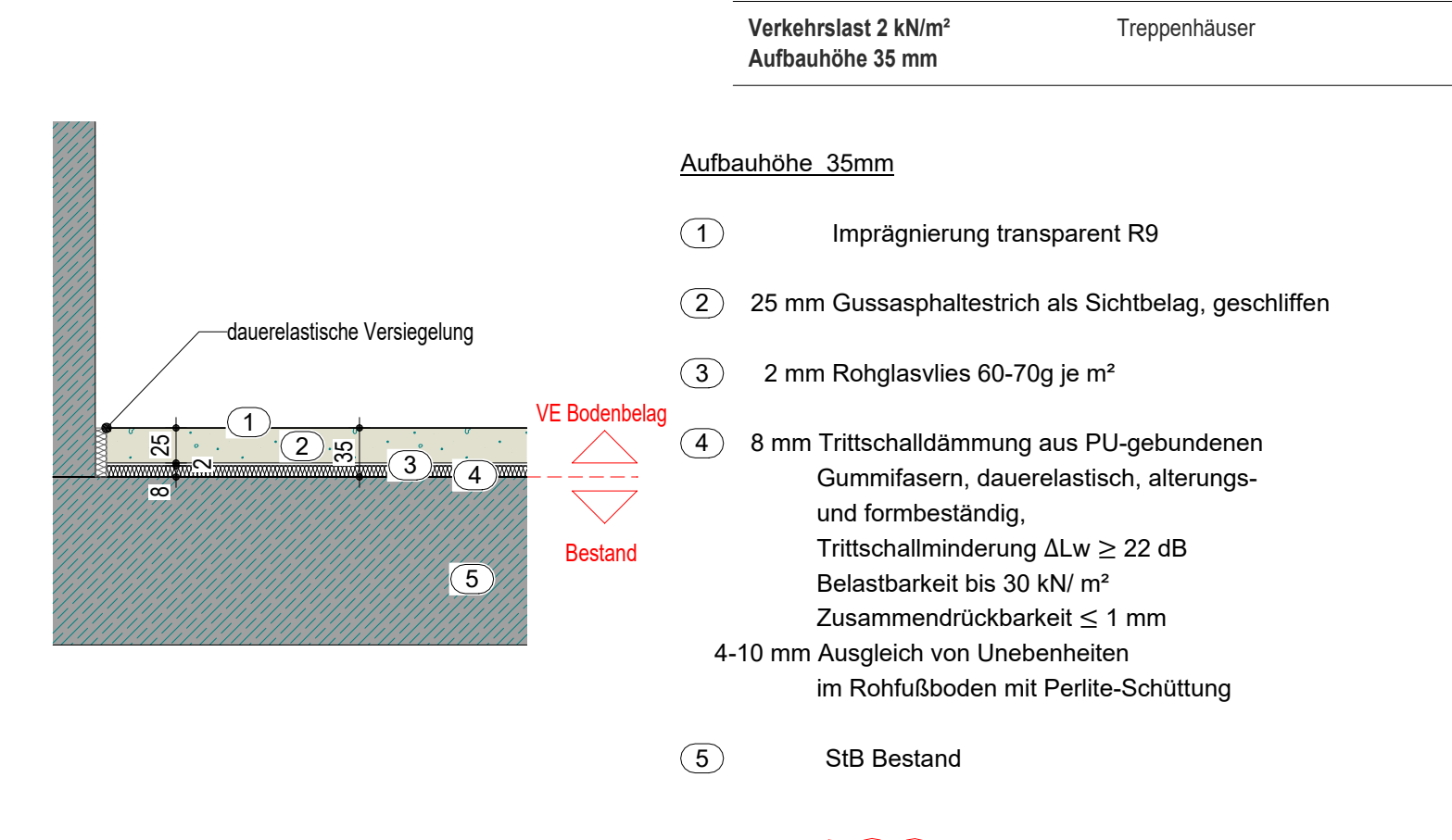

## E3 - 3.2

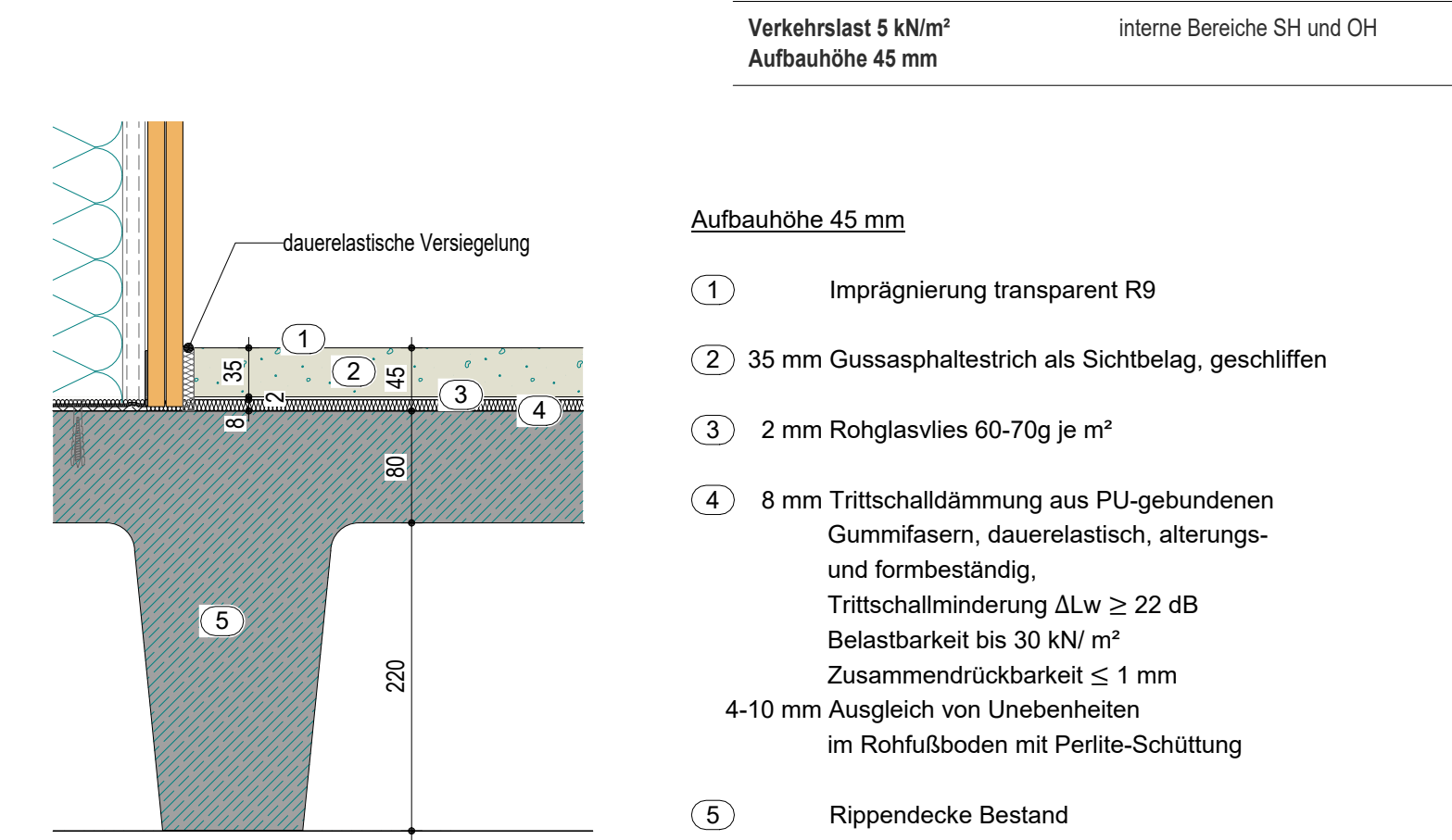

## E3 - 3.3

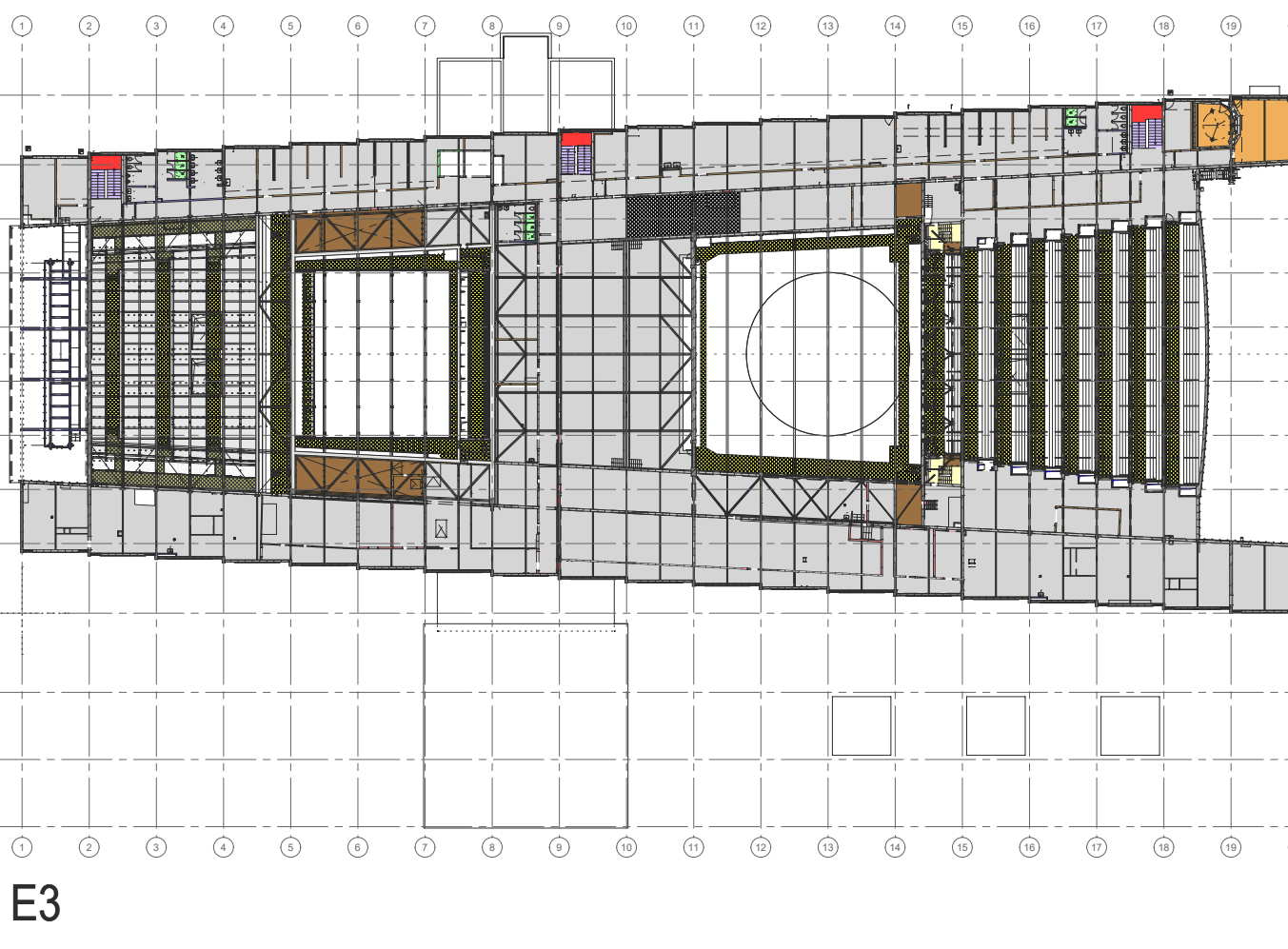
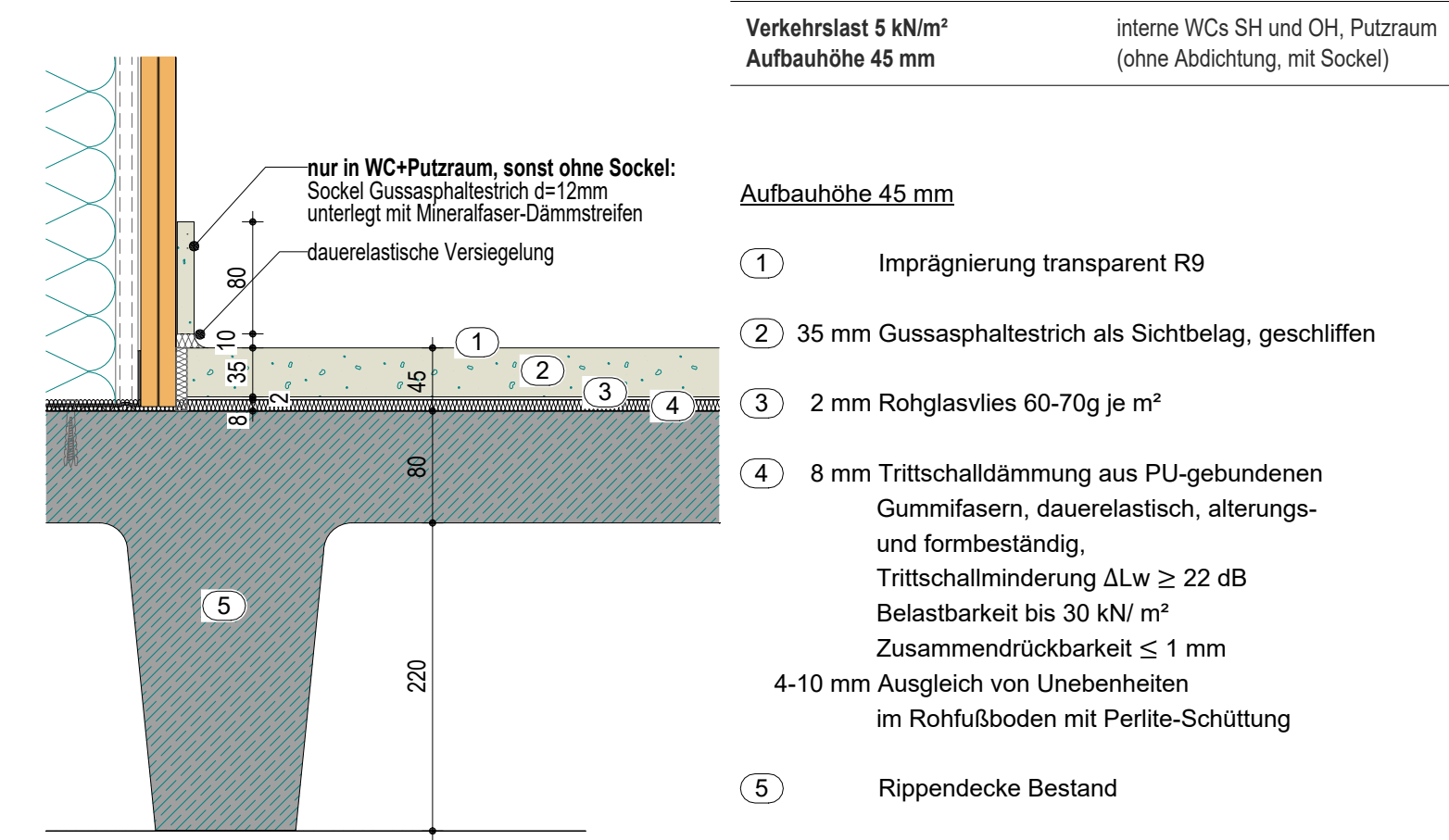

## E3 - 3.4

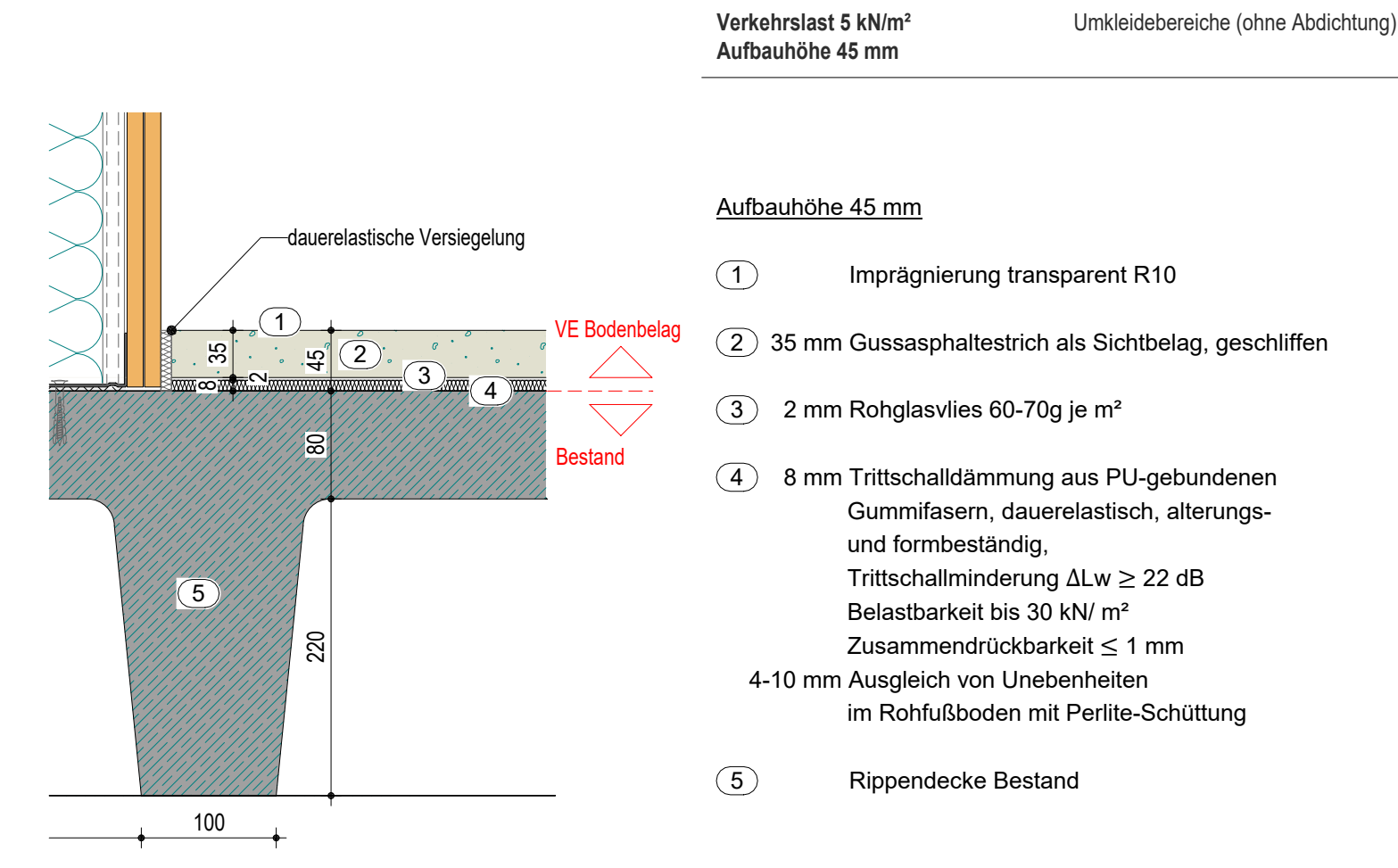

## E0 - 3.5 / Übergang zu 3.3

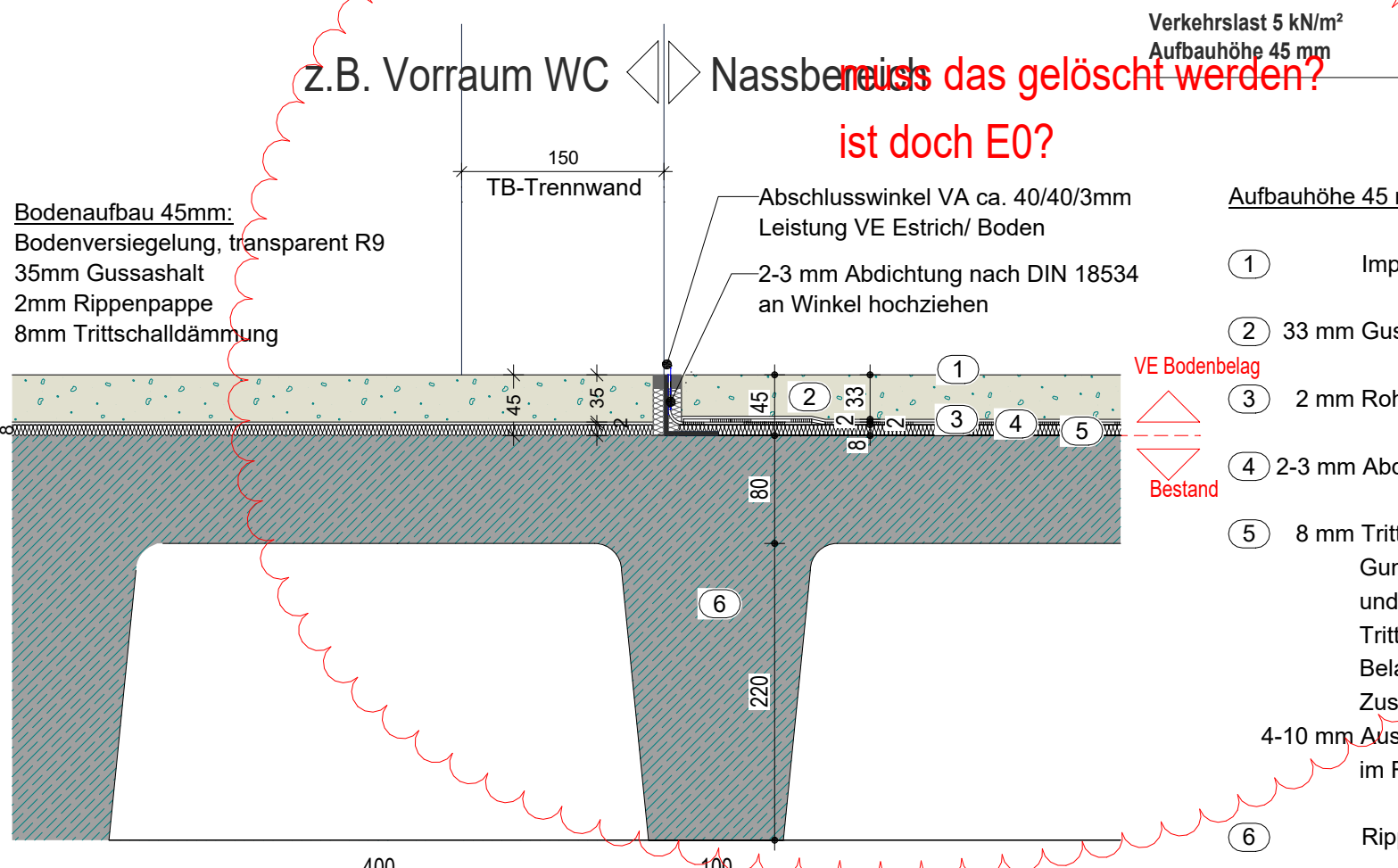

## E0 - 3.5 / Übergang zu 6.5

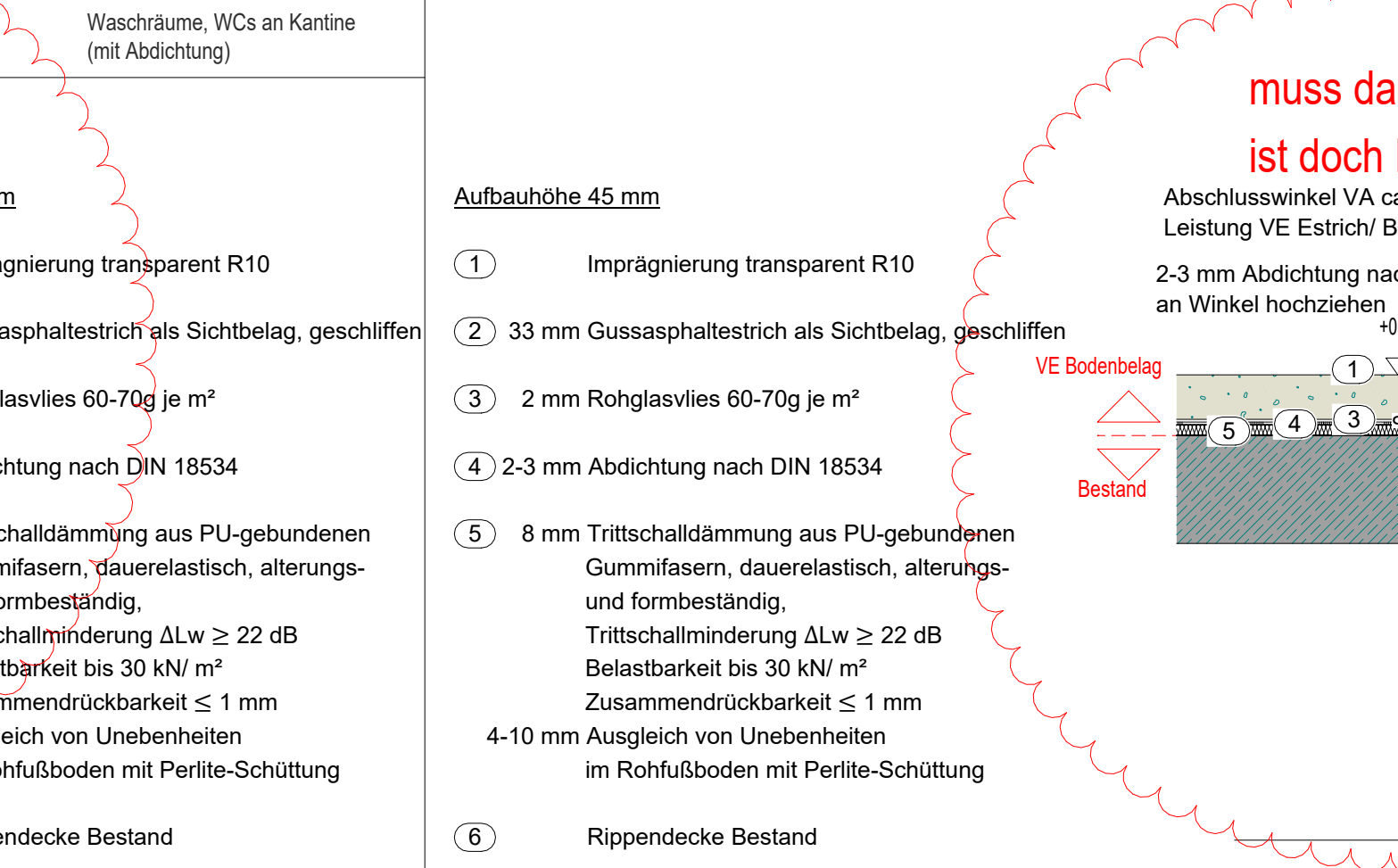

## E0 - Gussasphalt versiegelt R10

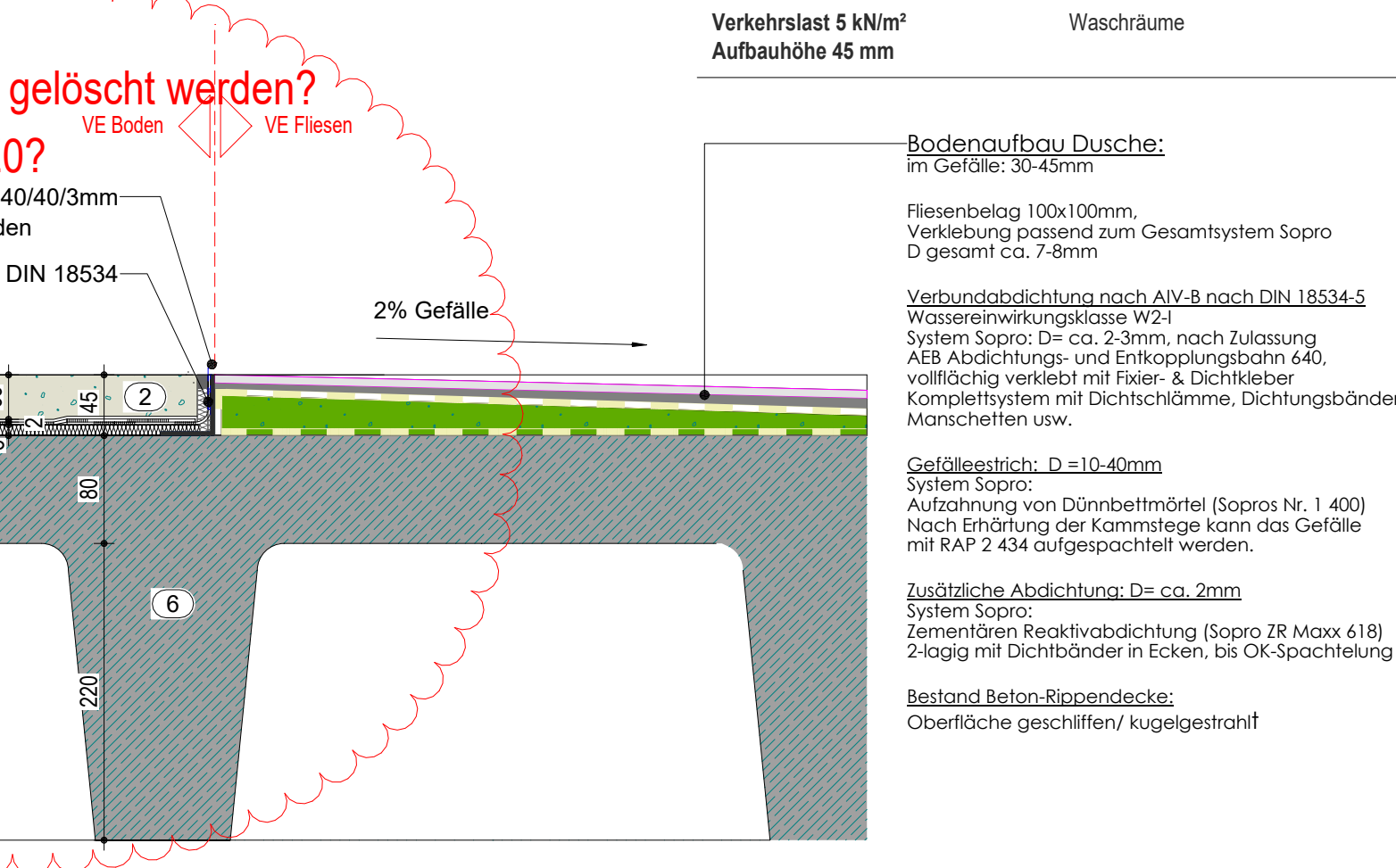

1.1-1.2 Beschichtung 1.4 Rohboden	4.1. Parkett neu / aufgearbeitet 4.6	6.5. Fliesen in Duschen 6.7	11.1. Elastischer Belag 11.2
1.3 Aufarbeitung Rohboden	5.1. Betonwerkstein neu 5.3	7.1. Beschichtung 7.8 rutschhemmend	12.1.3 Doppelboden Trepph. 12.4 Doppelboden E-Technik
2.1. Estrich auf Trennlage/ 2.5 Verbundestrich beschichtet	5.4 Terrazzo aufarbeiten	8.1. Teppich (Velours) 8.3 (Denkmalschutz)	13 Trockenestrich
2.6 Estrich auf Trennlage beschichtet hochbelastbar	5.4. Betonwerkstein 5.6 aufarbeiten	9.1.4 Bühnenboden 9.5 Bühnenb. (Doppelb.)	14.1. Noppenbelag 14.2
3.1. Gussasphalt versiegelt 3.25	6.1. Fliesen 6.4	10 Tanzboden	15.1. Boden Kühleize 15.2 Boden TK-Zelle

## E0 - 3.5

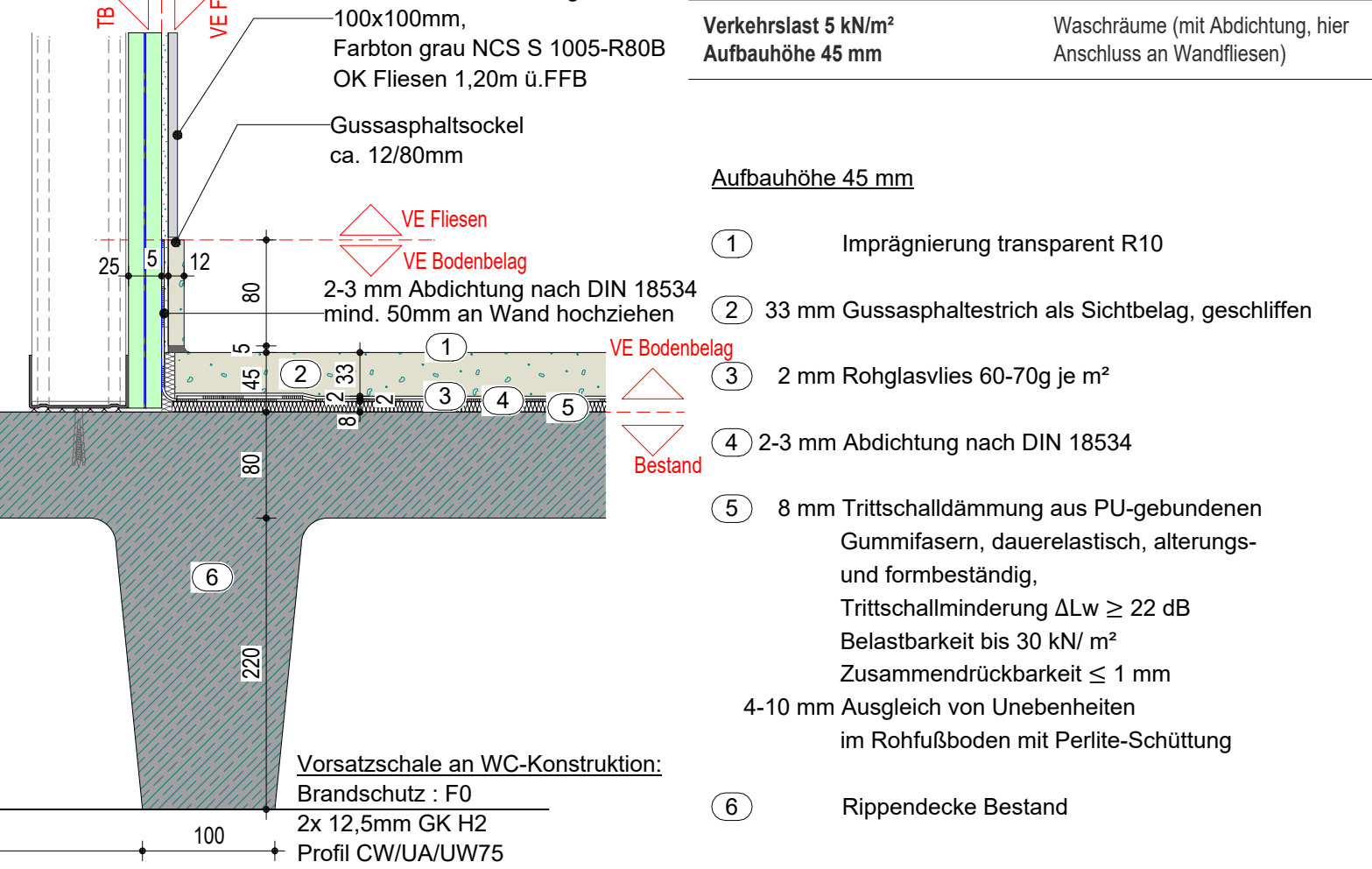

## E3 - 3.25

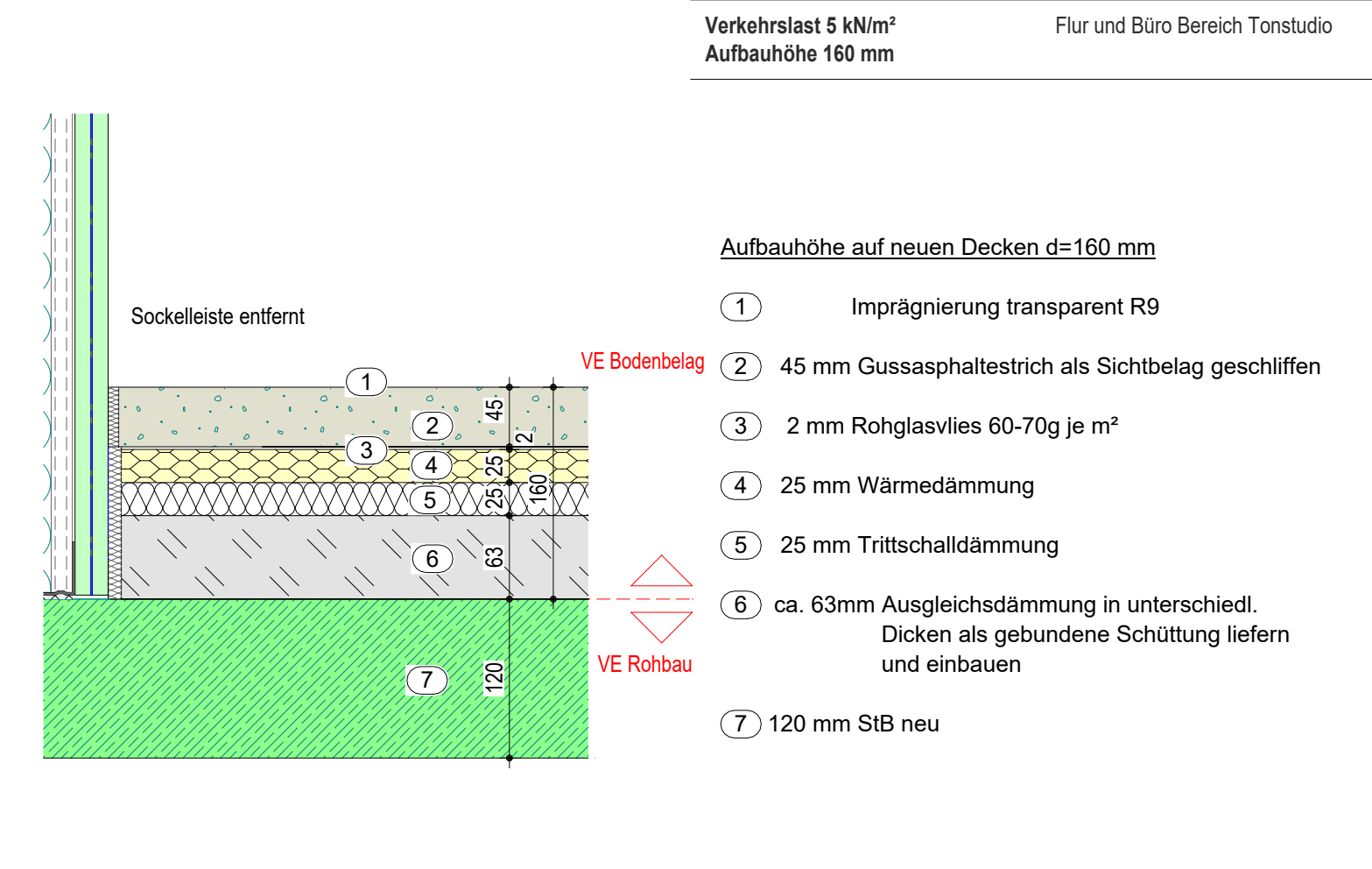

## E3 - 4.2

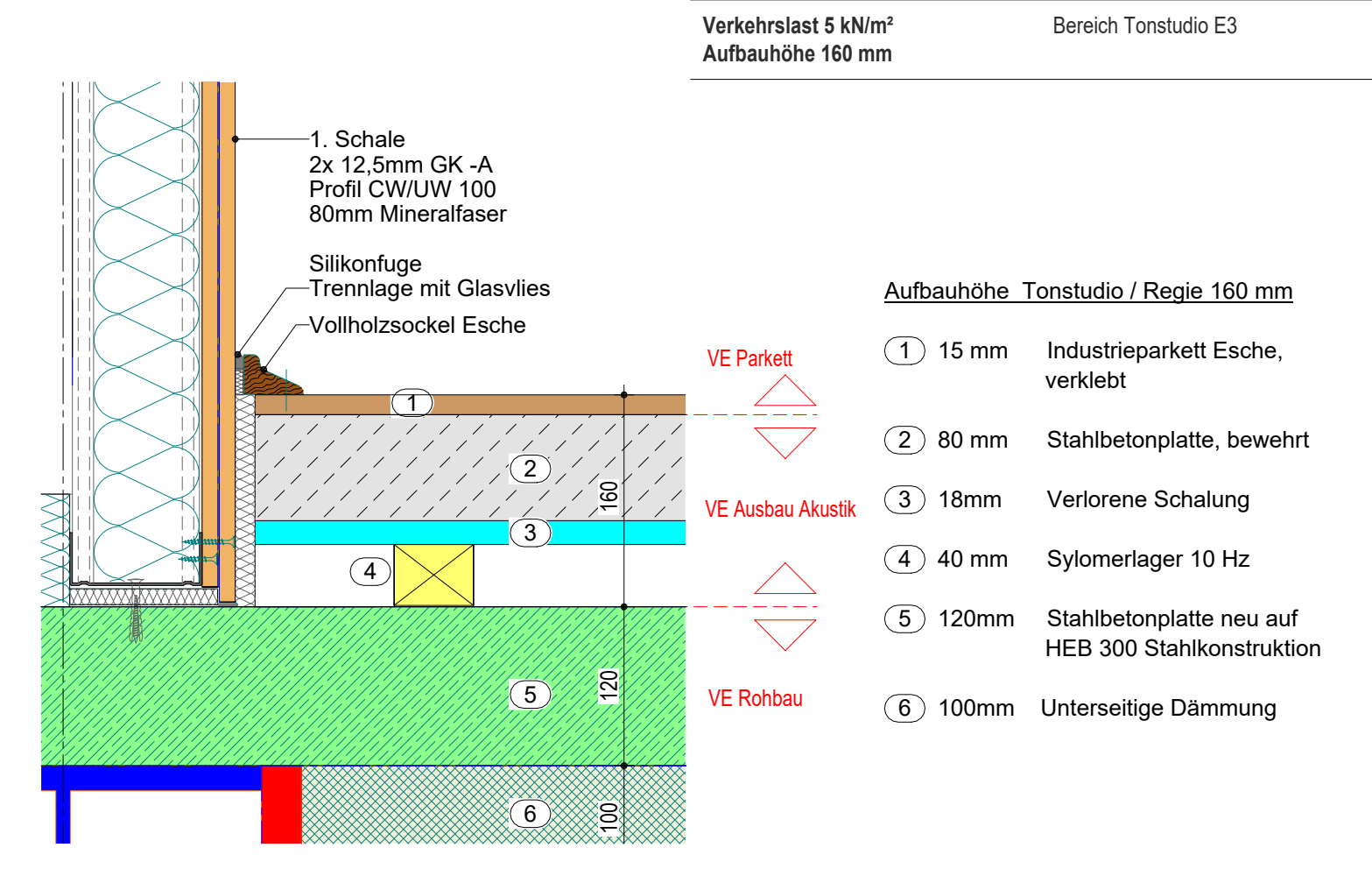

## E3 - 4.2

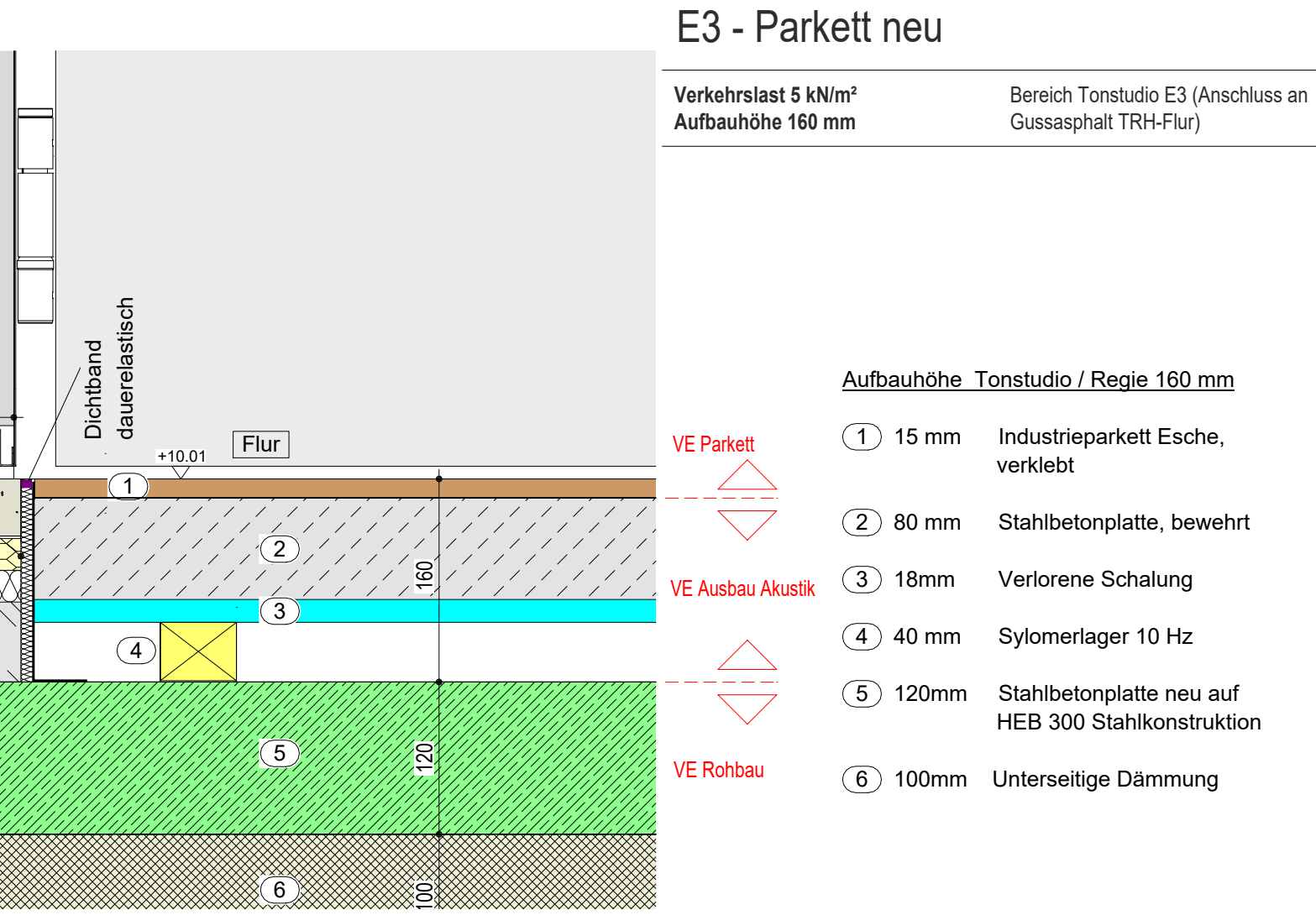
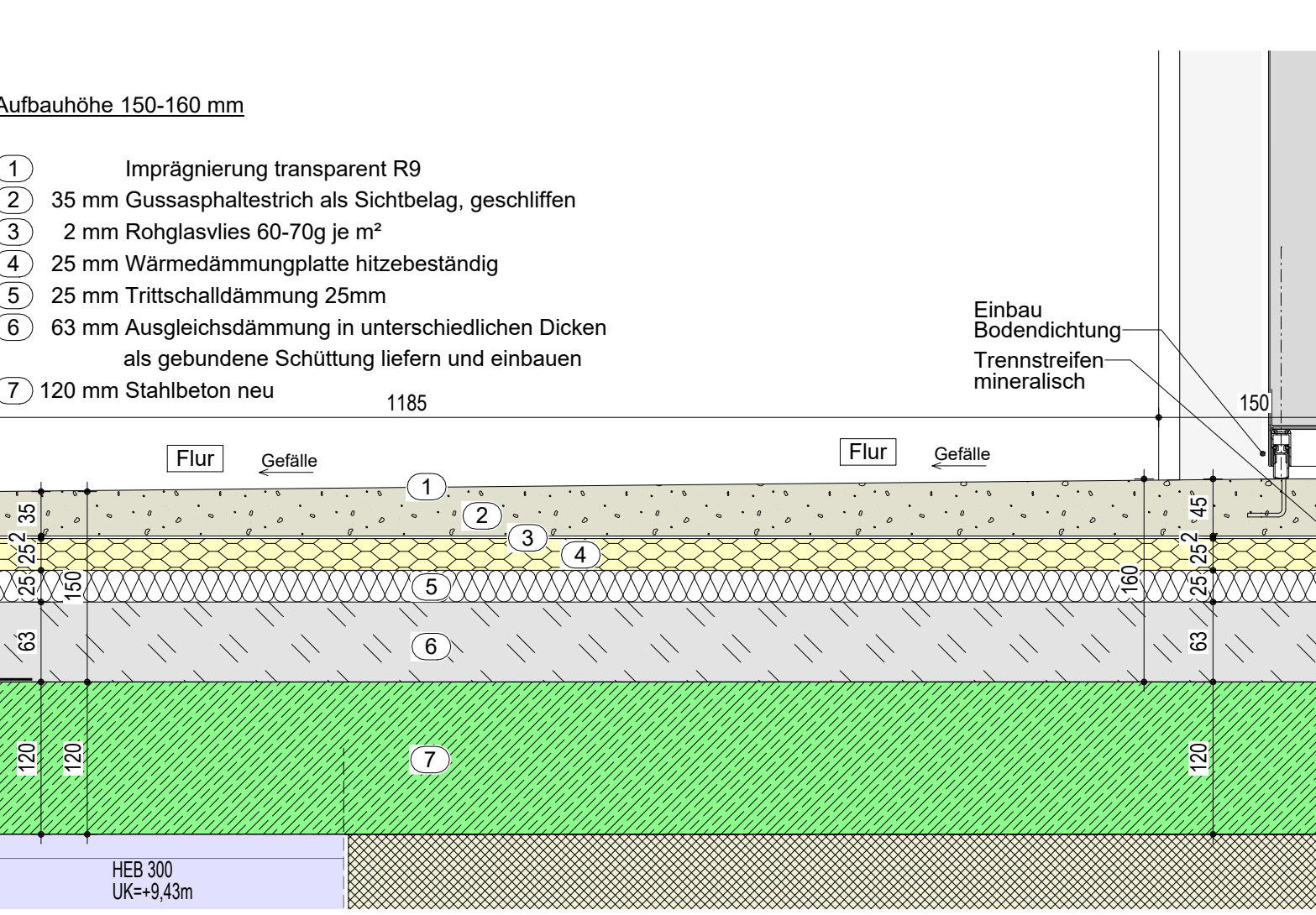
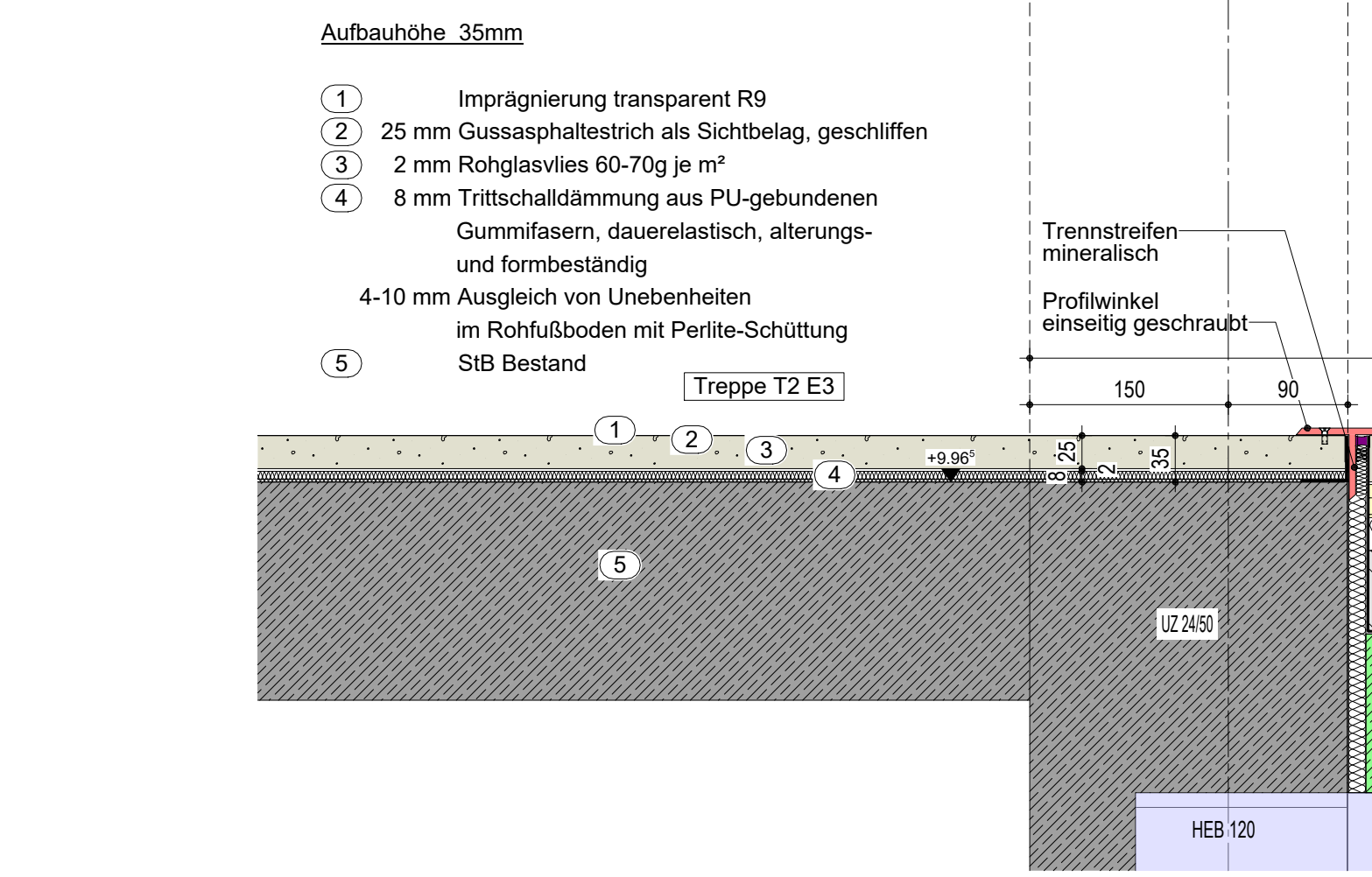

## E3 - 5.4

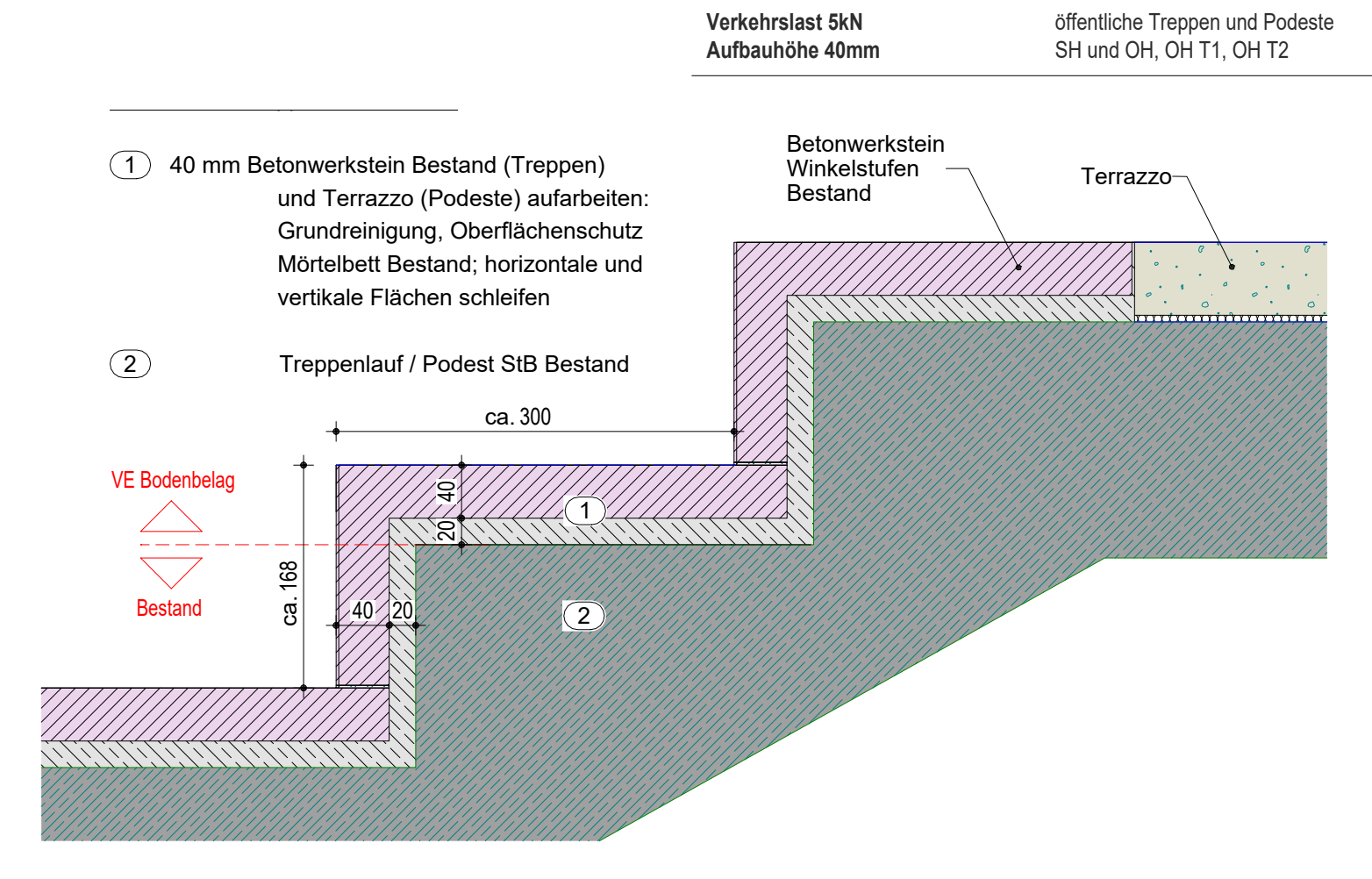

## E3 - 6.5

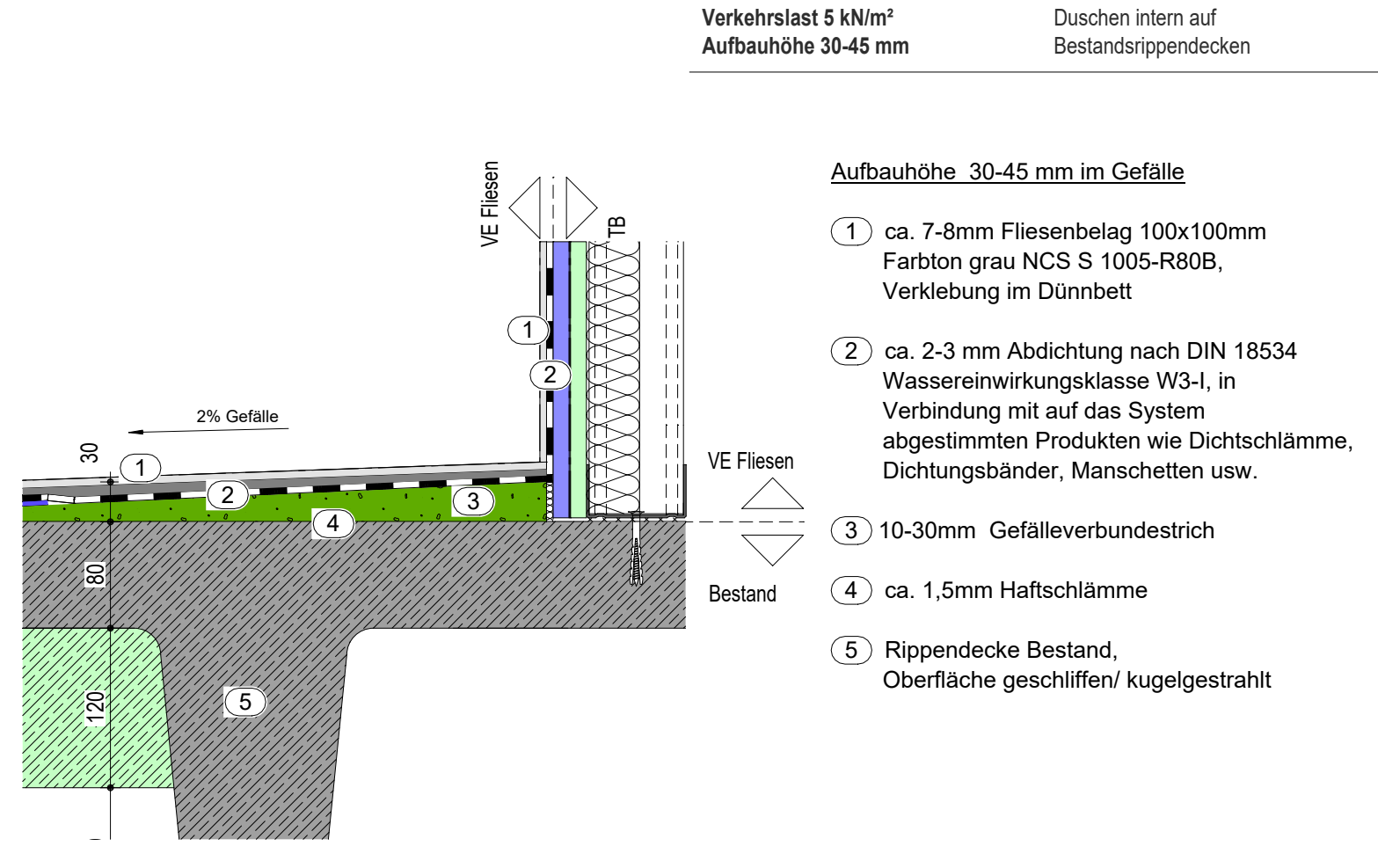

## E3 - 11.1

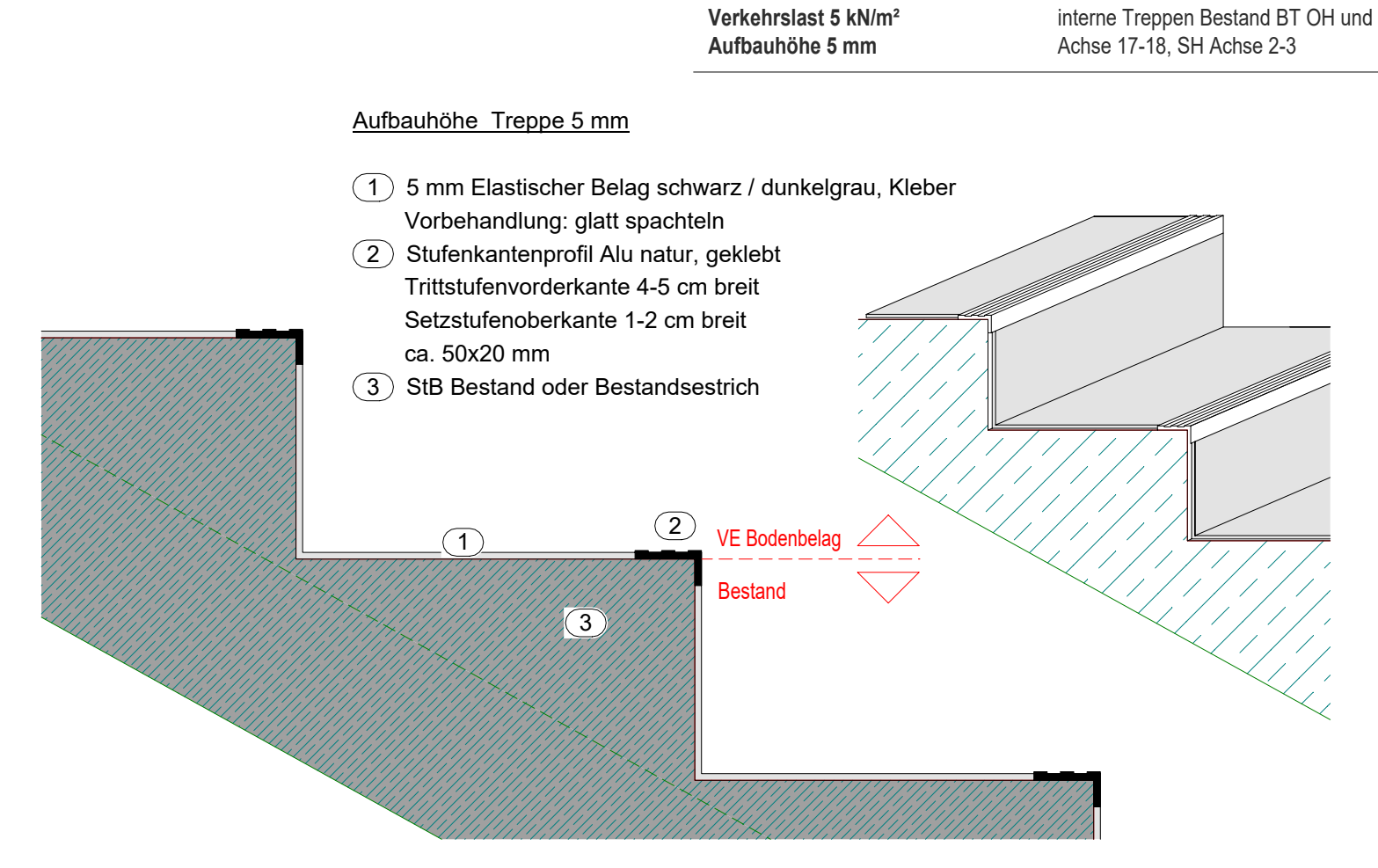

## E3 - 14.1

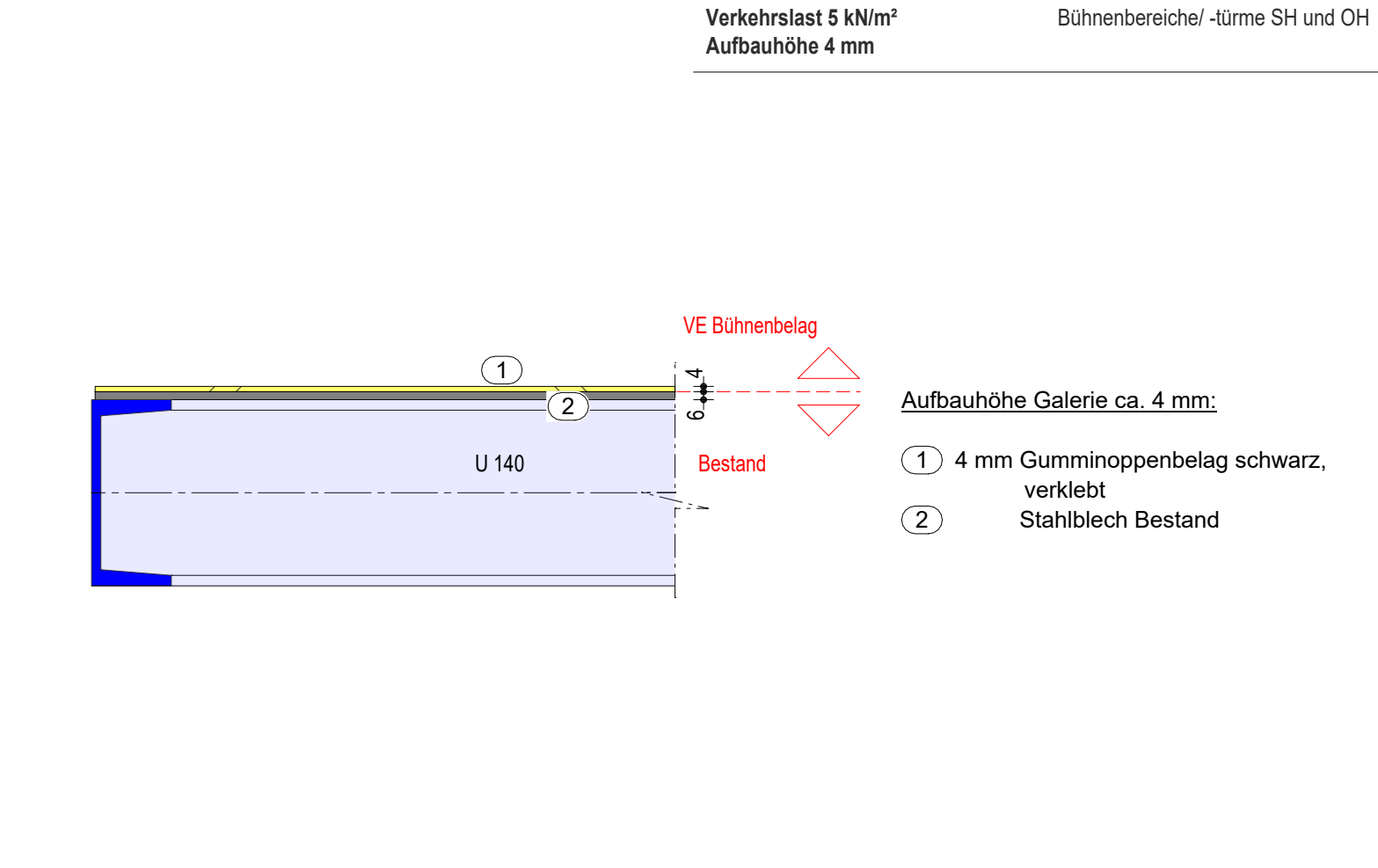

## E3 - 14.2

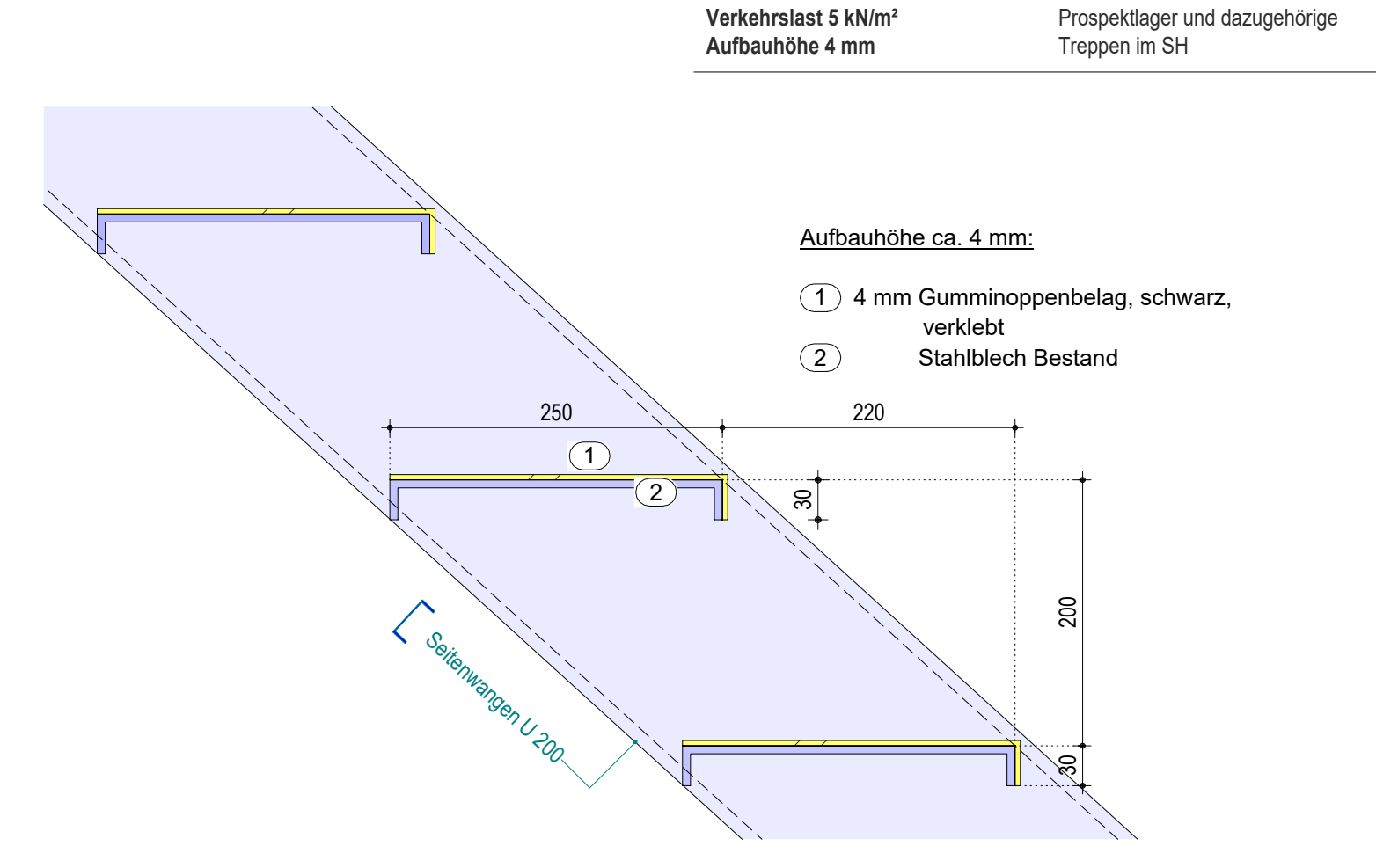

+0.00 (O-Gang) = 101.66 ü.NN

**AUSFÜHRUNGSPLANUNG**

BAUHERR: Stadt Mannheim vertreten durch Eigenbetrieb Nationaltheater Mozartstraße 9, 68161 Mannheim

**GENERALSANIERUNG NATIONALTHEATER MANNHEIM**

Spielhaus am Goetheplatz

PLANBEZ: DETAILS BODENAUFBAUTEN EBENE E3

PDF: 13.08.2025 CAD-PL-NR: 4134

DWG: MST: 1:5

BEARD: GEZ: BLATT-NR./ INDEX: XX-5-AR-XX-4134-DT-E3-7