

1 Anschluss Tür SUz - BP02/BP04

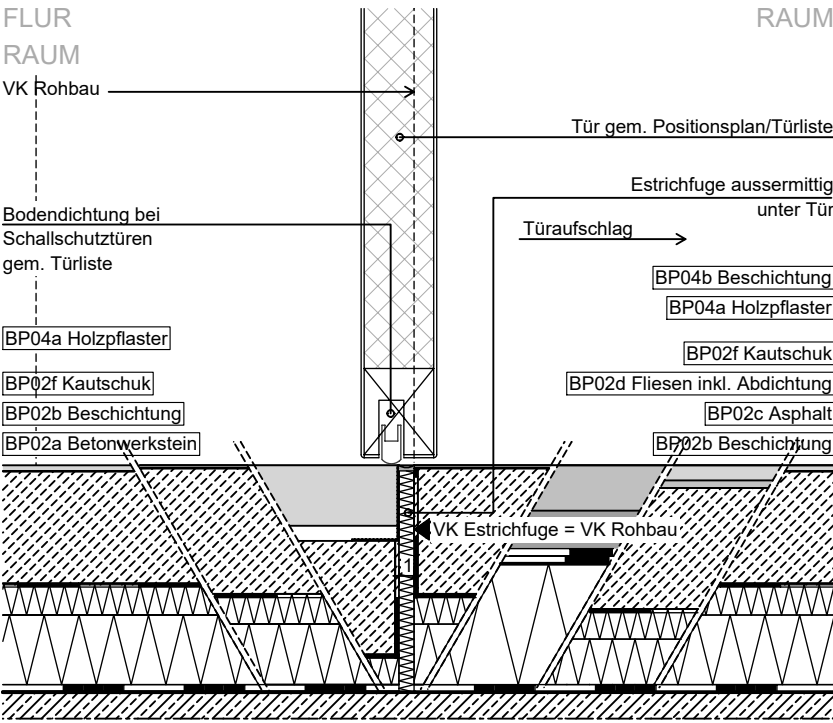

1 Anschluss Tür SUz - DE01

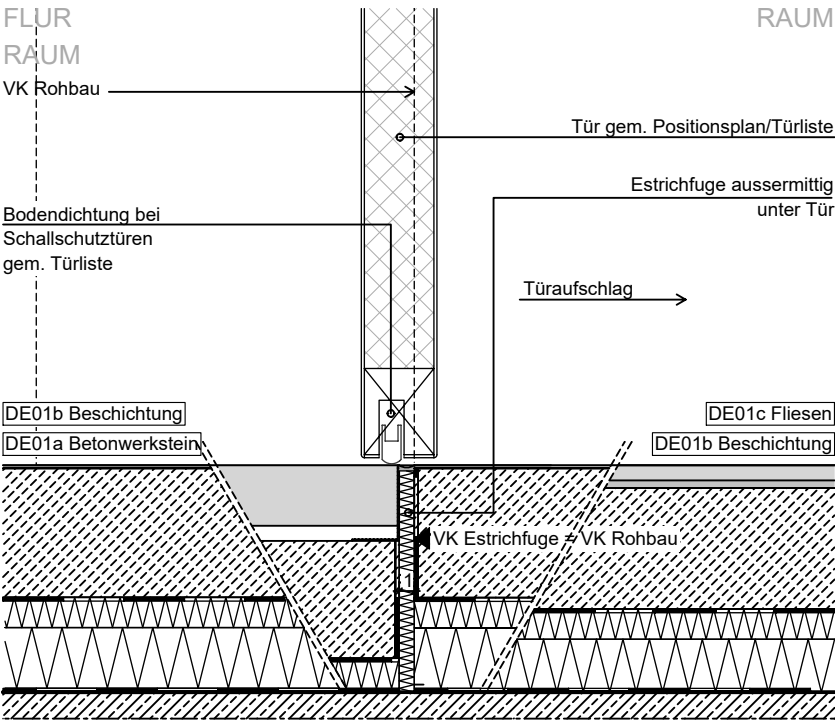

2 Anschluss Tür MRG - DE01/BP02

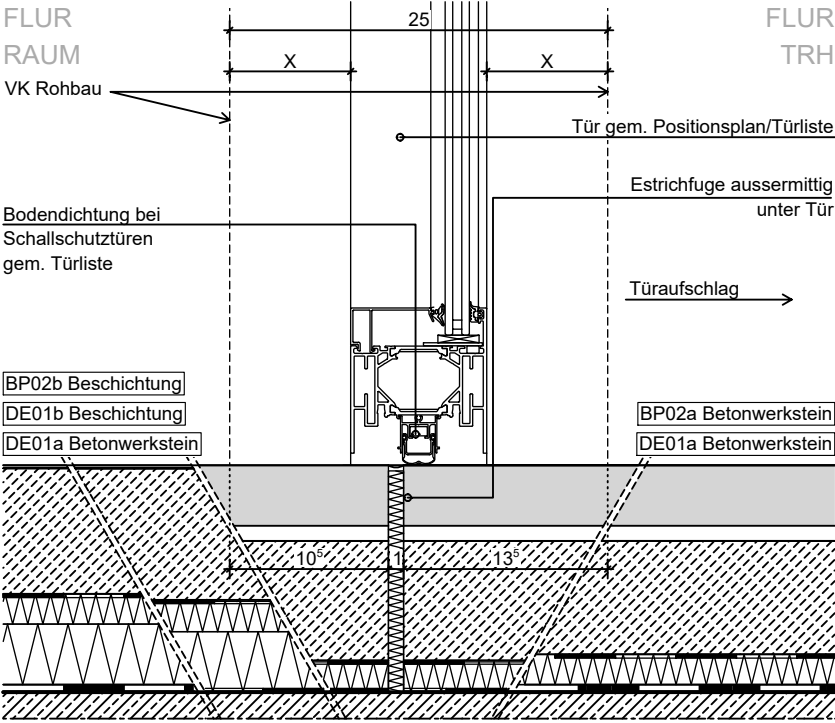

2 Anschluss Tür MRG - DE02

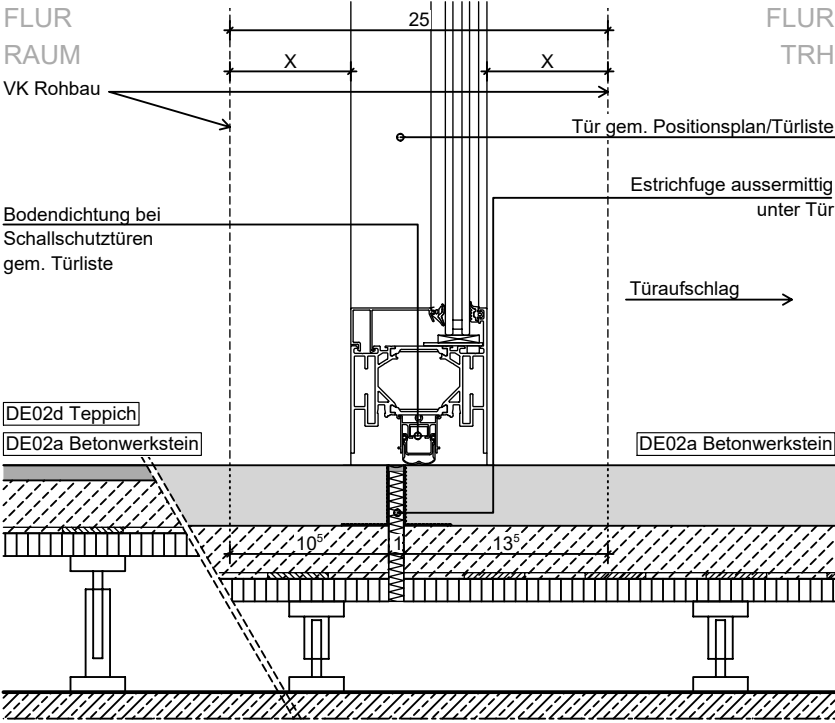

3 Anschluss Tür MRG - BP04

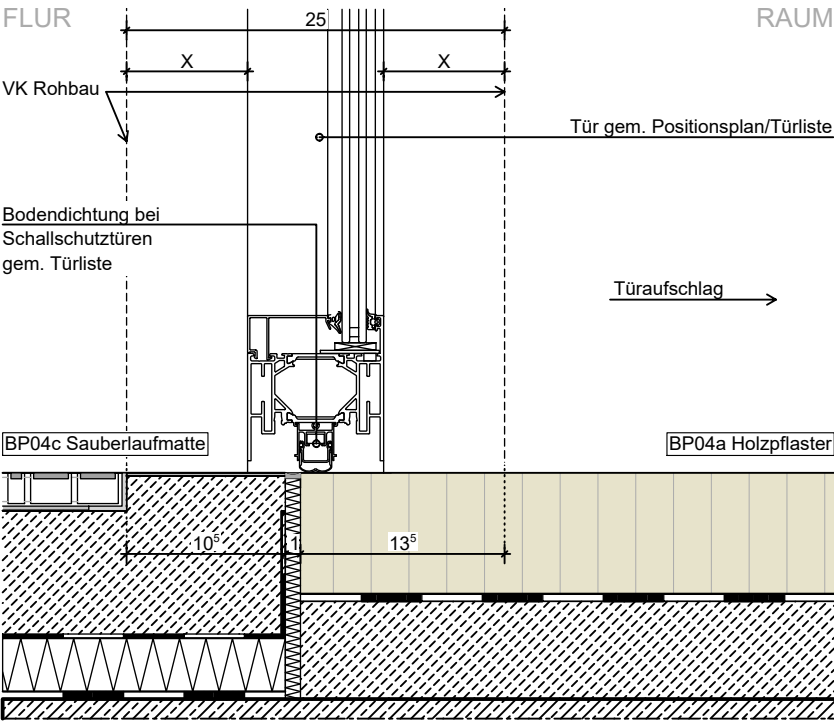

4 Anschluss Tür MRG - DE01/DE02

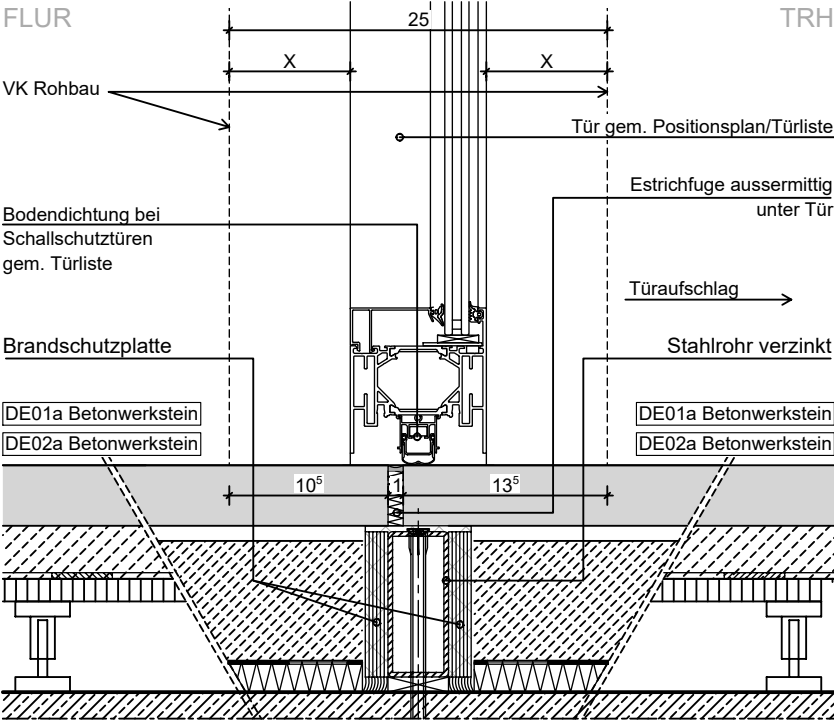

5 Anschluss Tür SUz - DE02

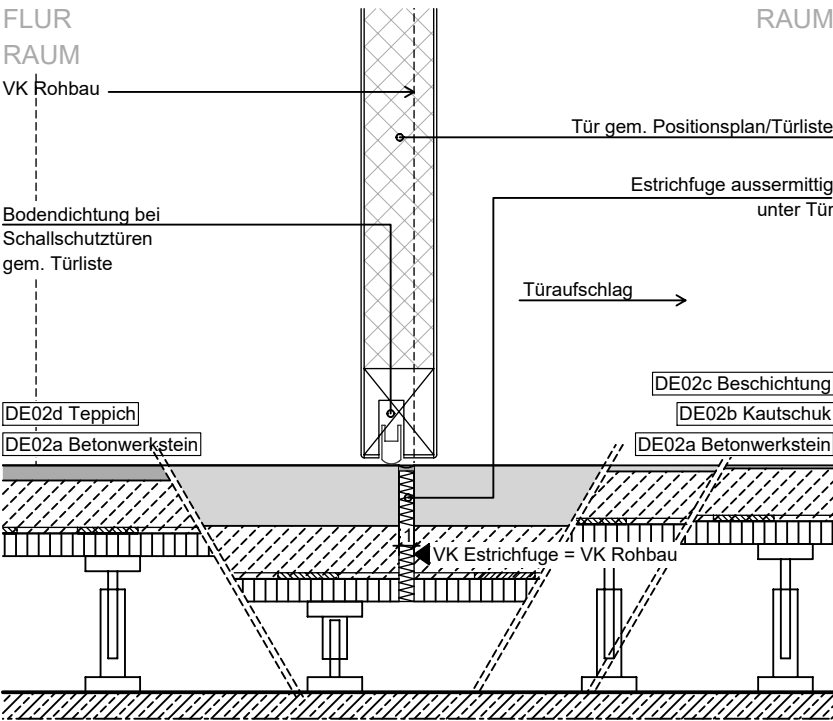

6 Anschluss Tür SUz - DE02/DE01

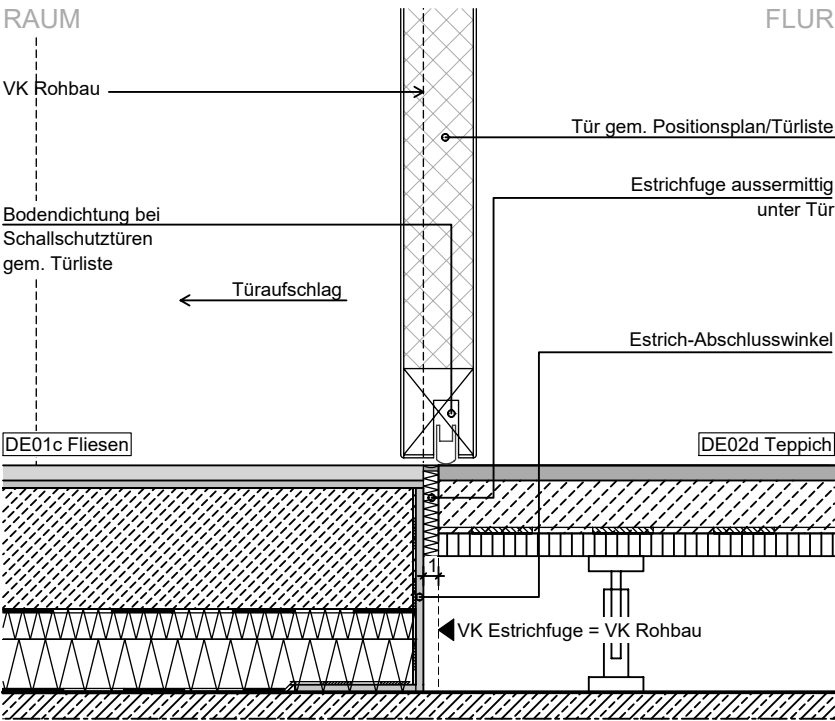

7 Anschluss Tür SDfz - DE02/DE01

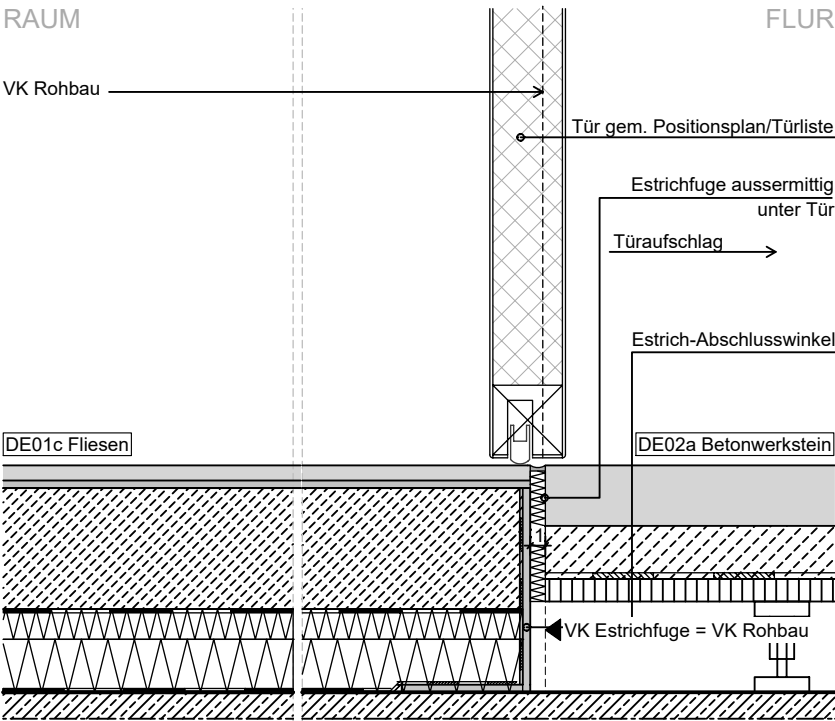

8 Anschluss Tür SDfz - DE02/DE03

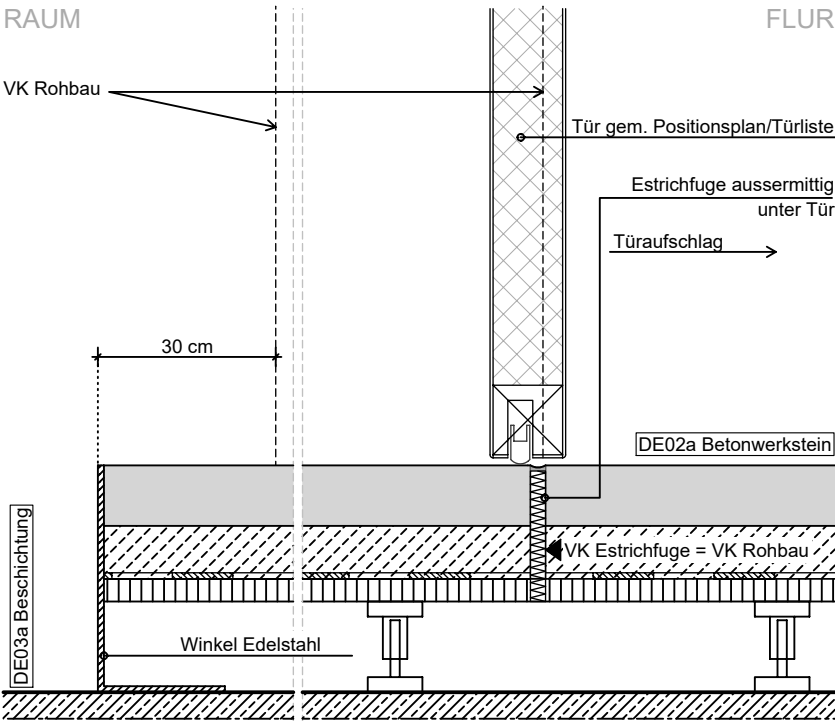

9 Anschluss Tür SDfz - DE01/BP02, BP04

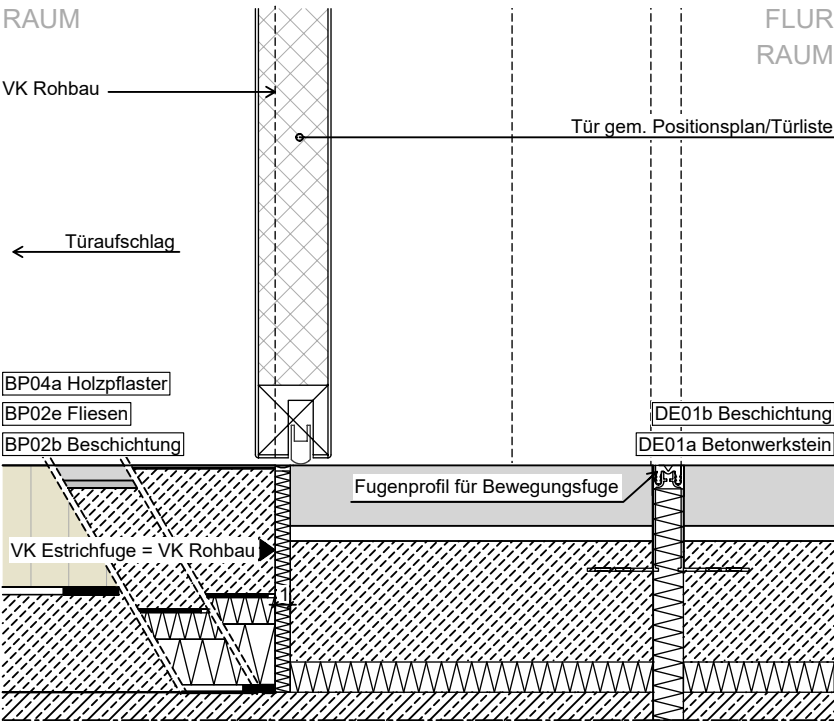

10 Anschluss Tür HUZ - DE02

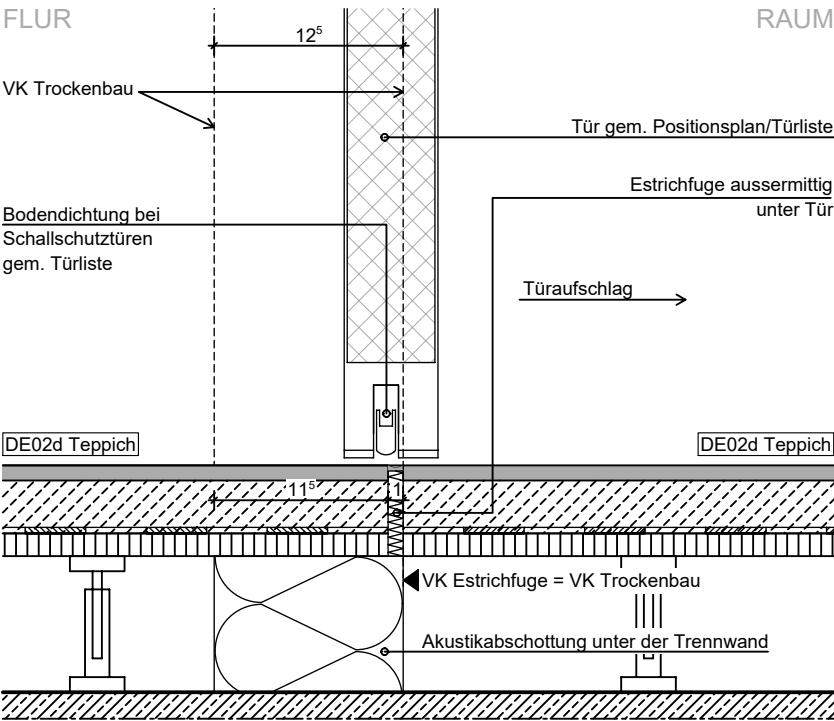

MAI_ABS_5.823_DT_Bodenanschlüsse_Tür

PROJEKT
NEUBAU HWK ZENTRUM BAU
Neubau des Berufsbildungszentrums II (BBZ II)

BAUHERR
Handwerkskammer Rheinhessen
Körperschaft des öffentlichen Rechts
Dagobertstraße 2, 55116 Mainz

VORABZUG

PLANNR./INDEX

5.823

Maßstab

1:5

Planformat

750 x 297

Gezeichnet

BB / AR / BB

Planstand

Planstand 14.10.2025