

GRUNDRISS ERDGESCHOSS M 1 : 50

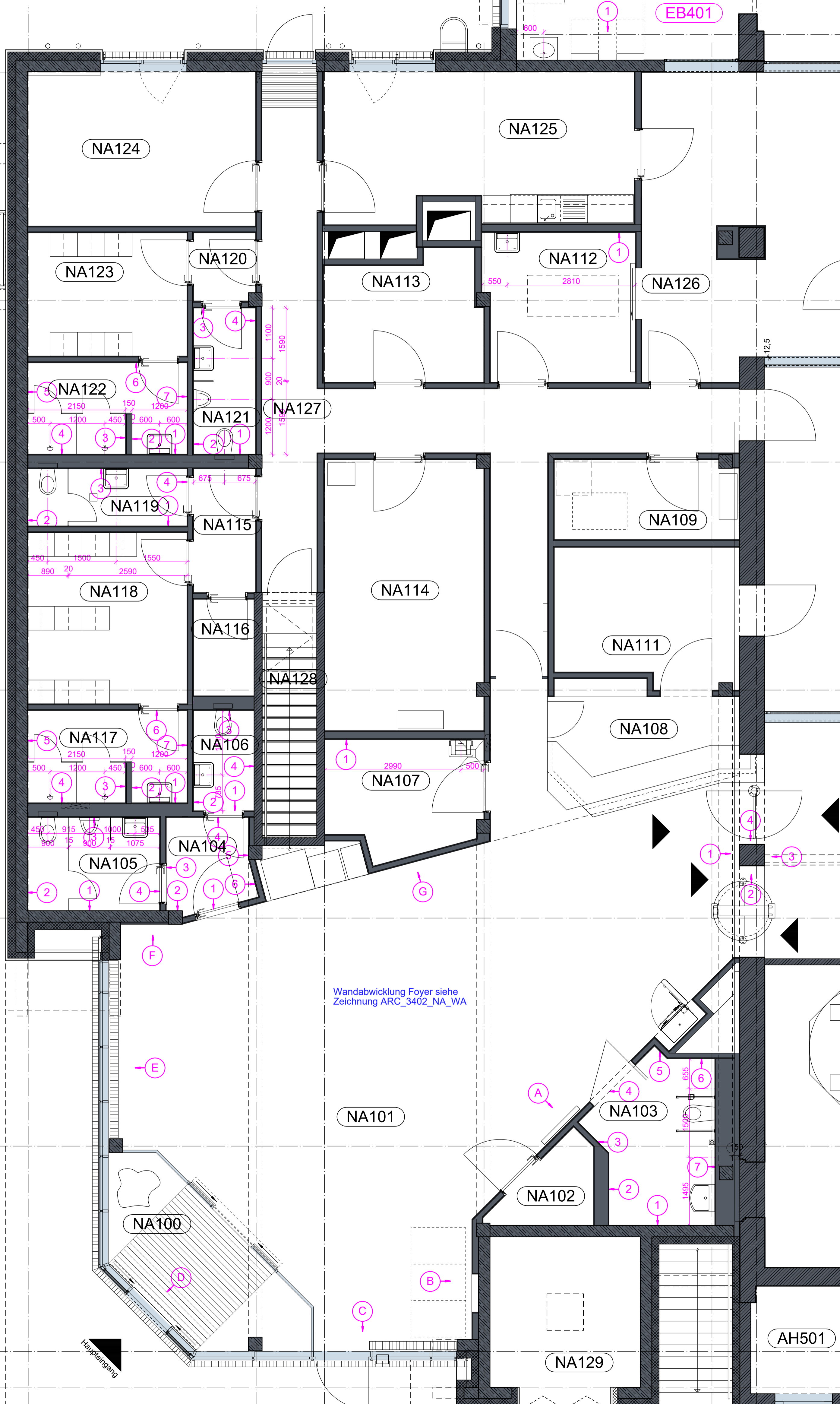

WANDABWICKLUNG RAUM NA103 M 1 : 50

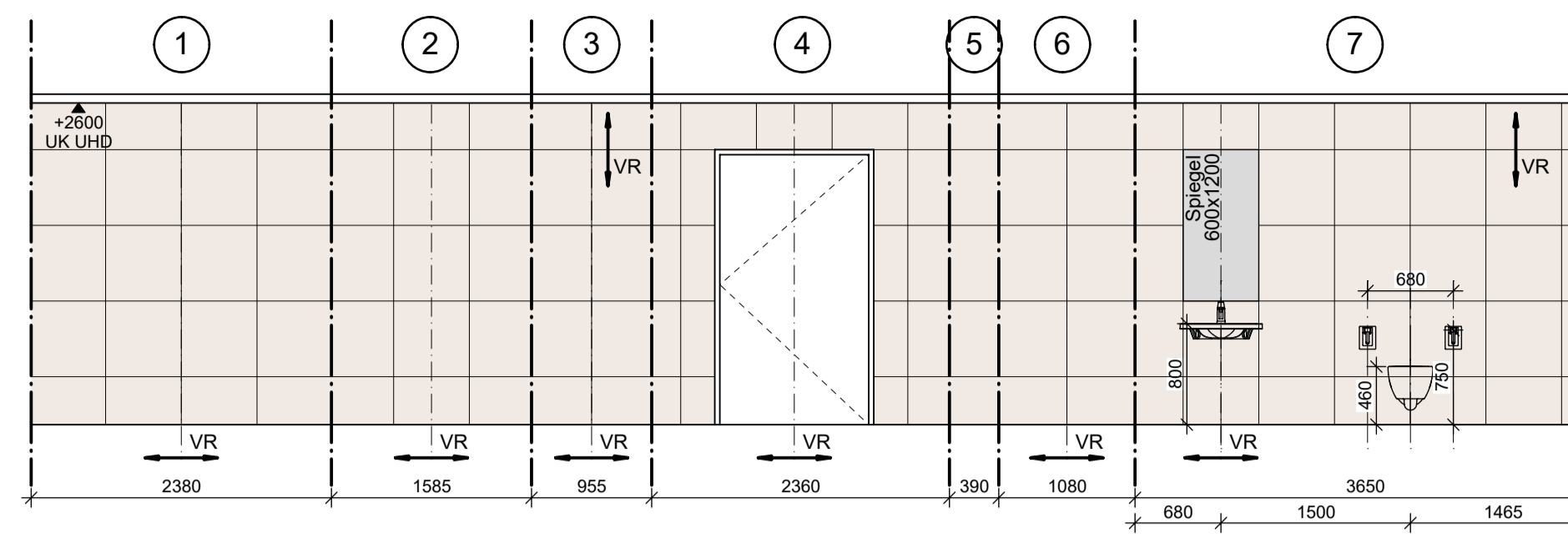

WANDABWICKLUNG RAUM NA104 M 1 : 50

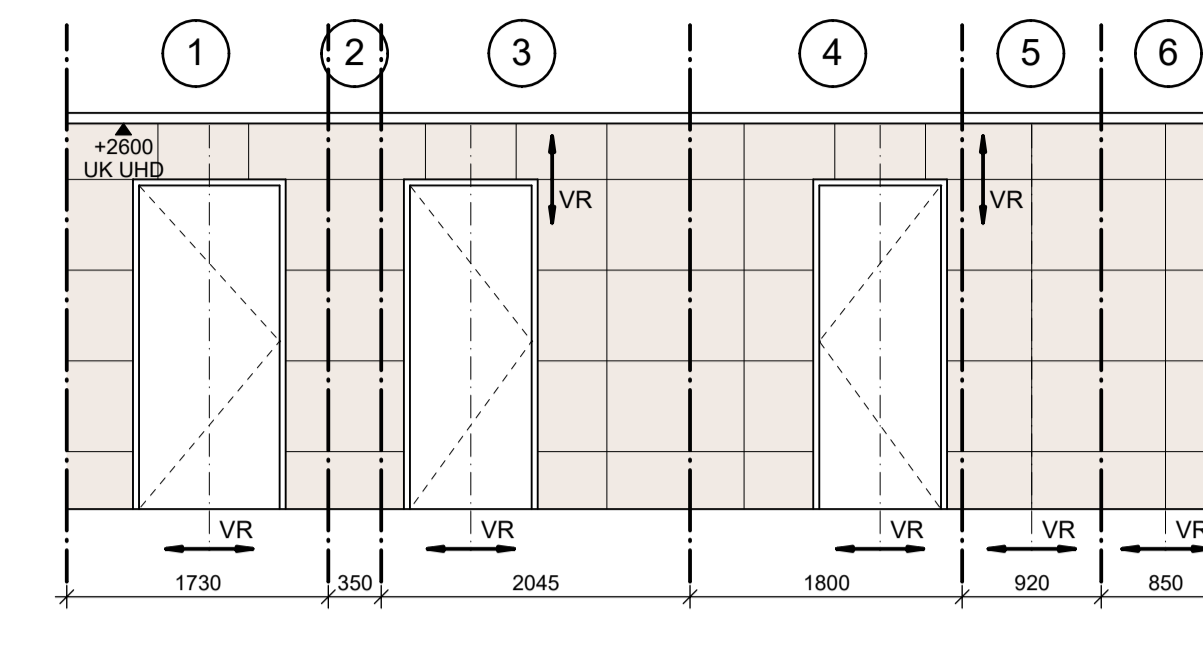

WANDABWICKLUNG RAUM NA105 M 1 : 50

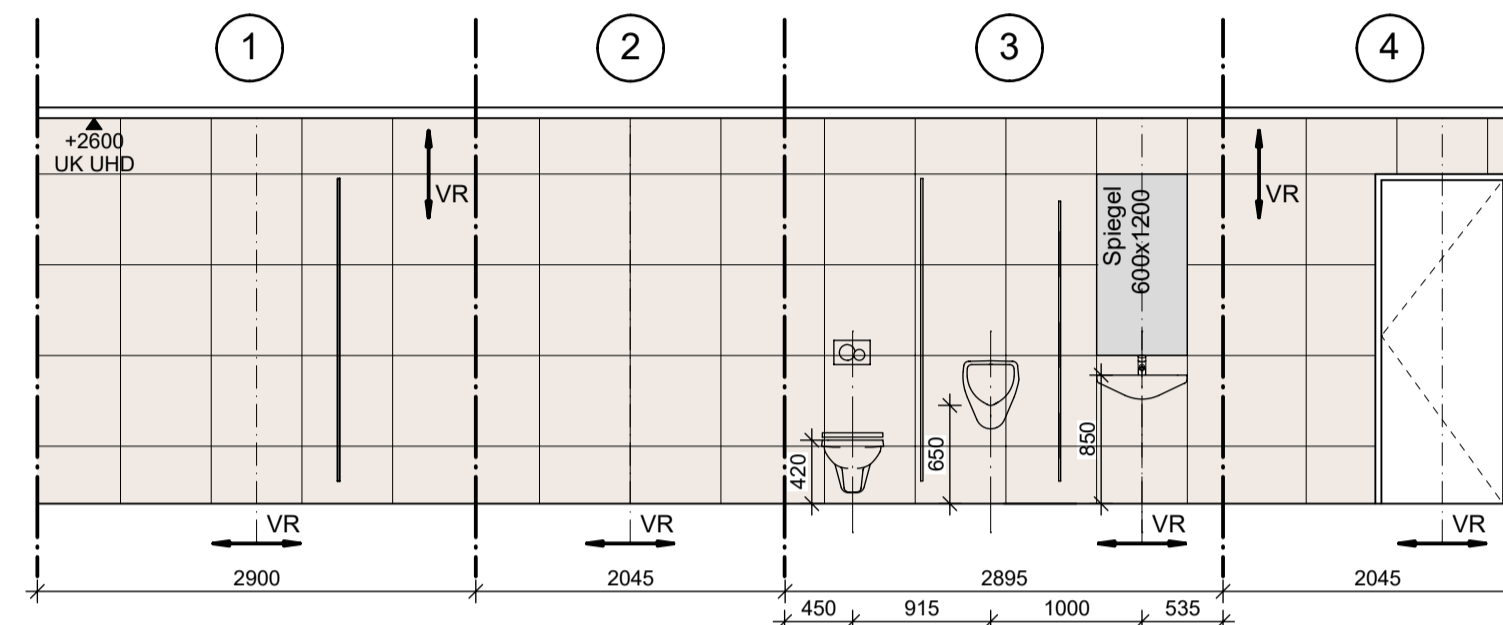

WANDABWICKLUNG RAUM NA106 M 1 : 50

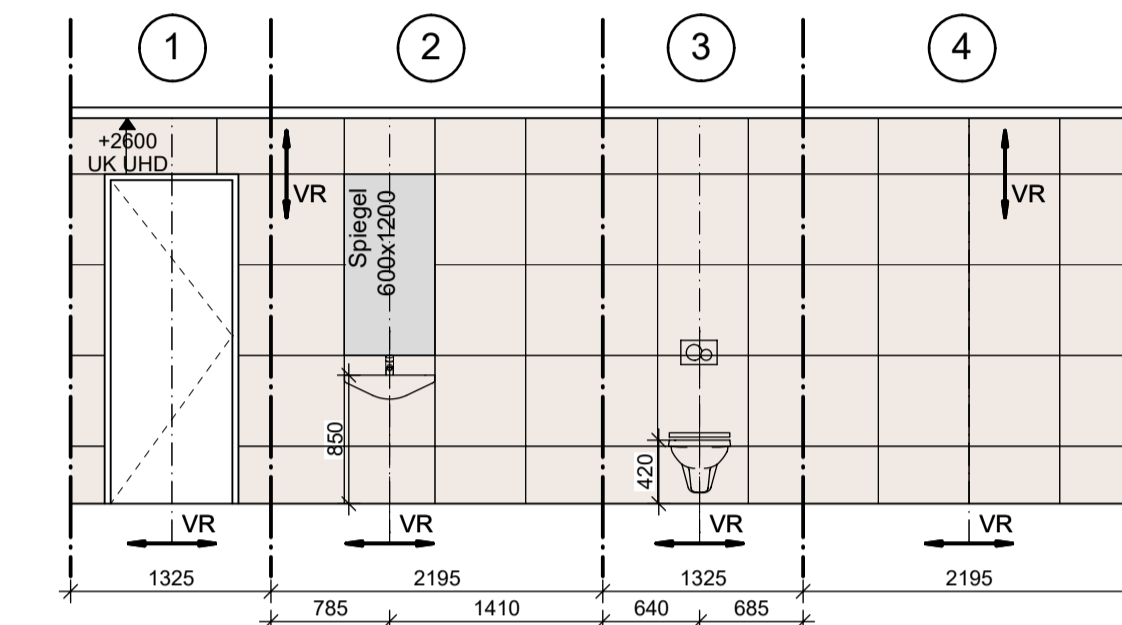

WANDABWICKLUNG RAUM NA107 M 1 : 50

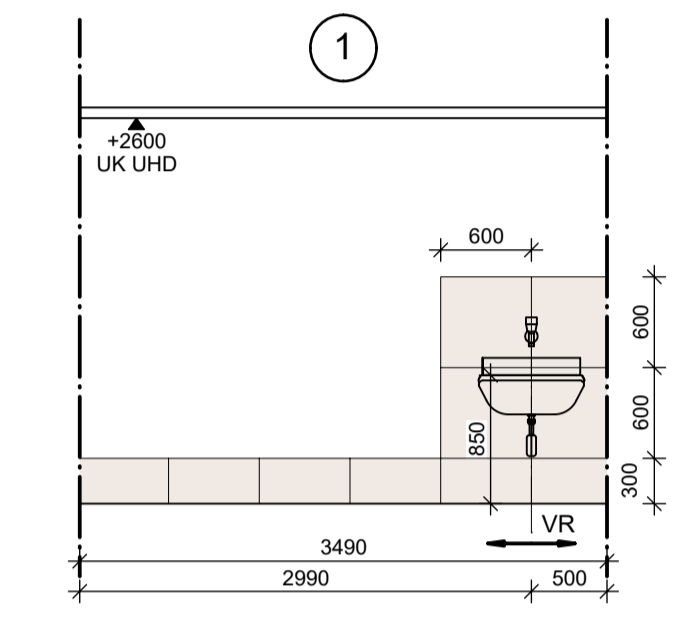

SÄULE AM DREHKREUZ
M. 1 : 50

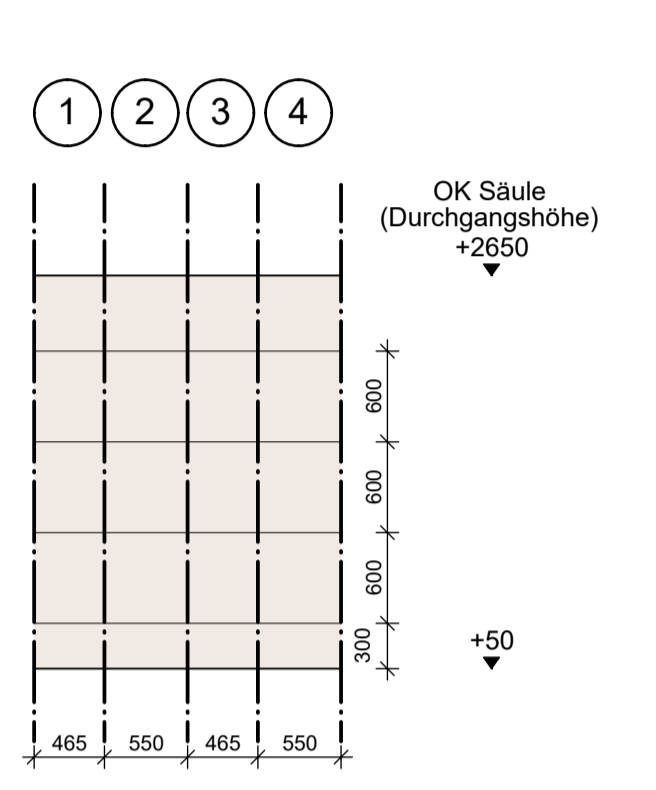

WANDABWICKLUNG RAUM NA117 M 1 : 50

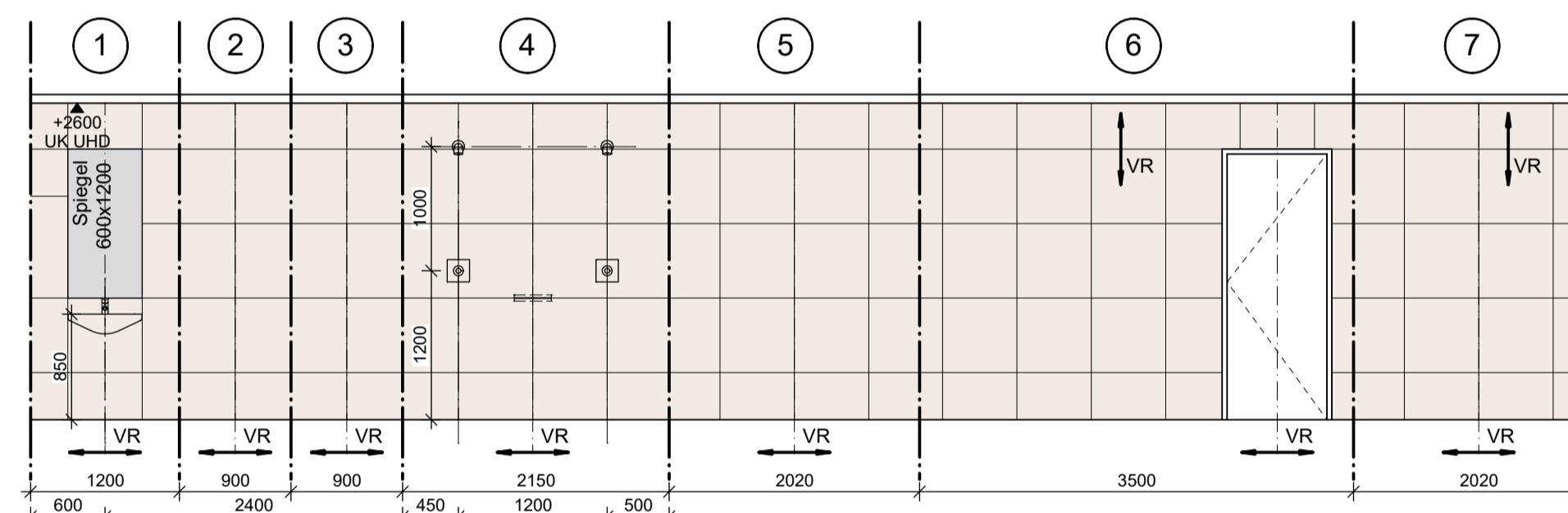

WANDABWICKLUNG RAUM NA119 M 1 : 50

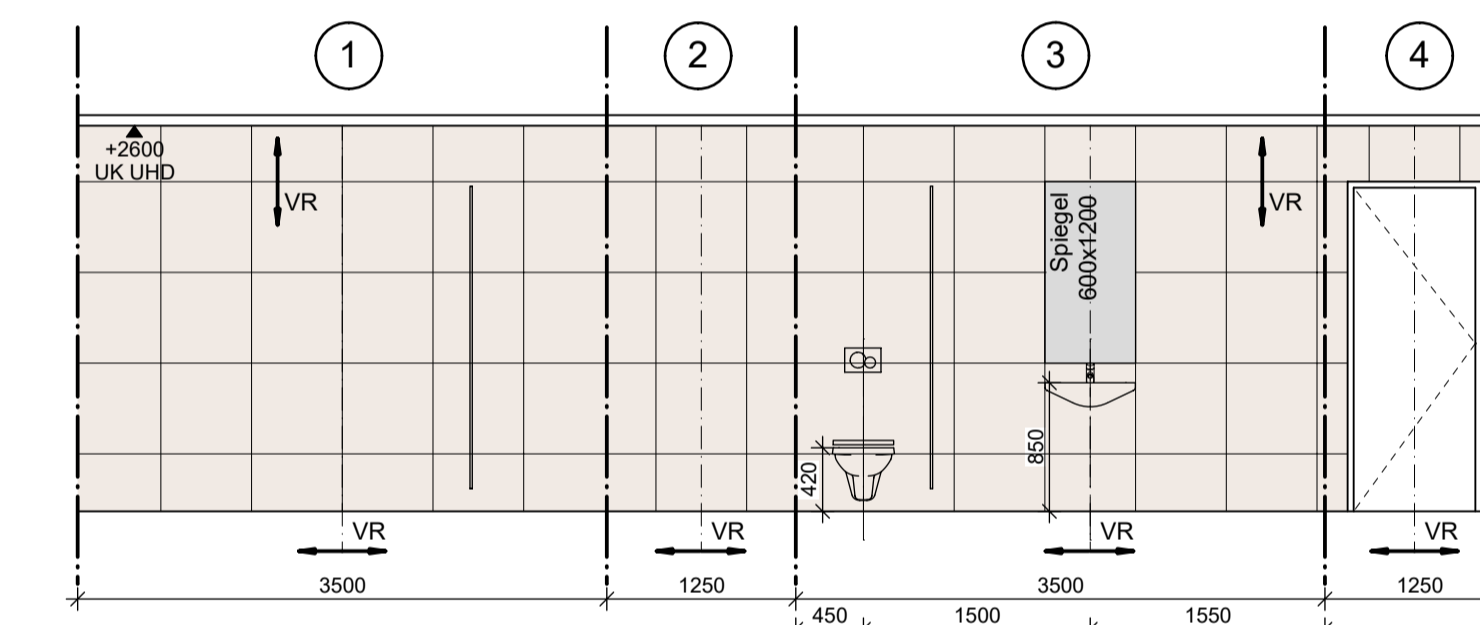

WANDABWICKLUNG RAUM NA121 M 1 : 50

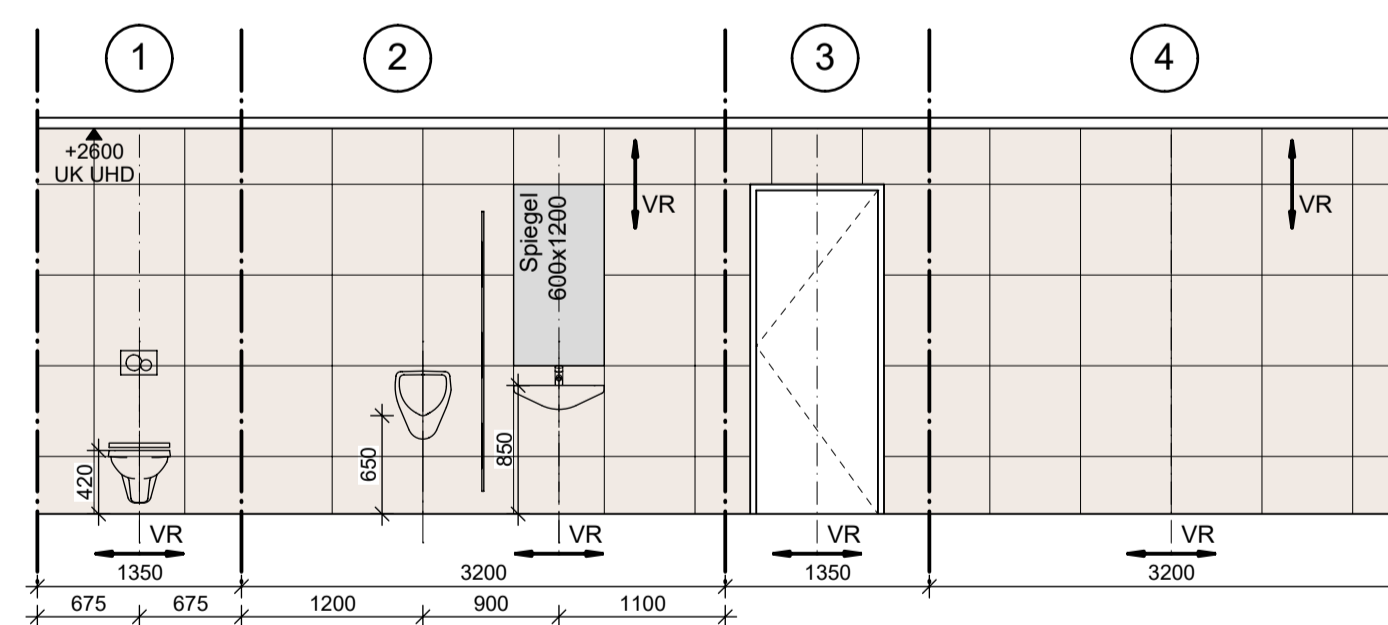

WANDABWICKLUNG RAUM NA122 M 1 : 50

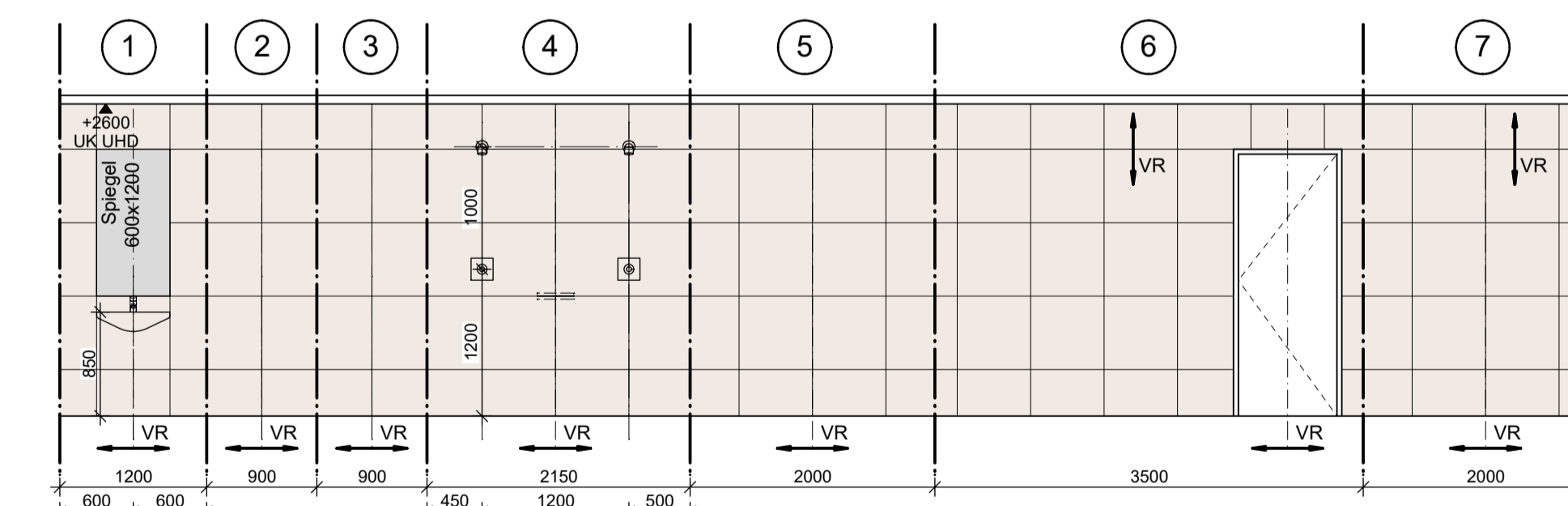

WANDANSICHT 1 - RAUM EB401 M. 1 : 50

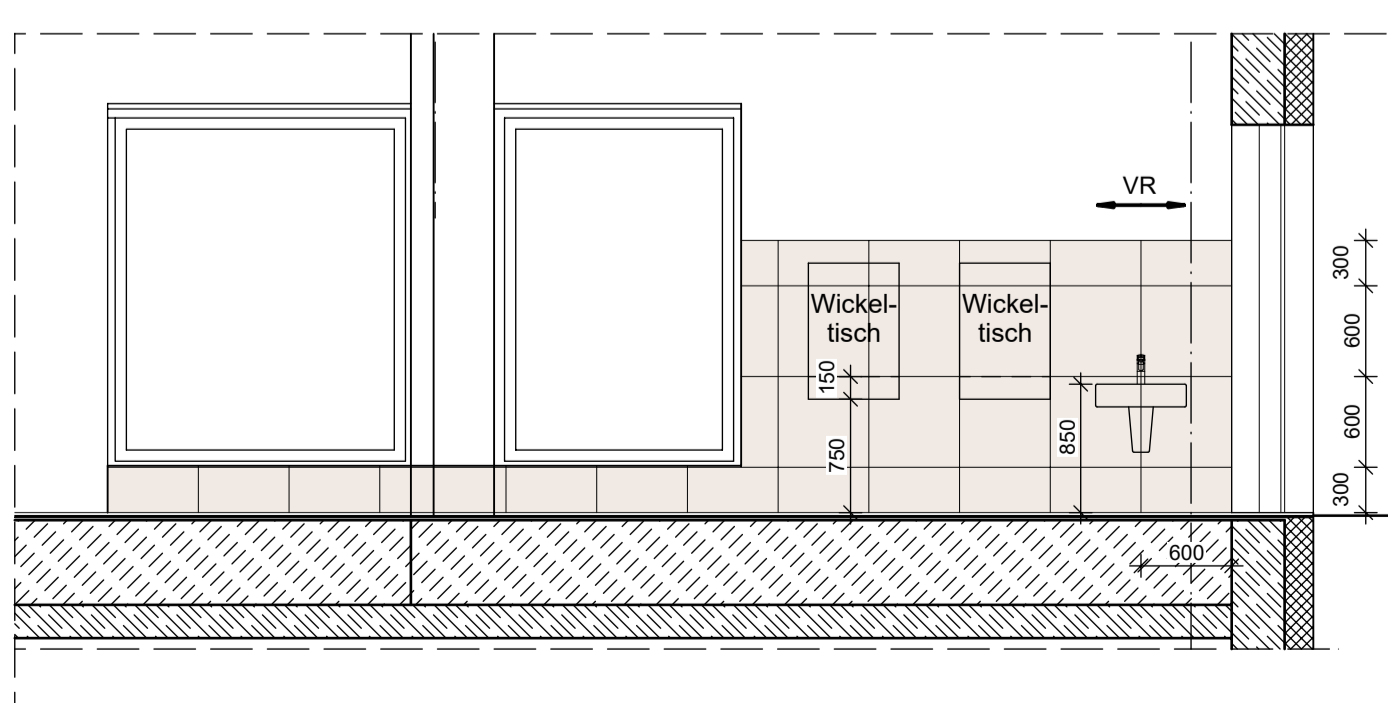

WANDABWICKLUNG RAUM NA112 M 1 : 50

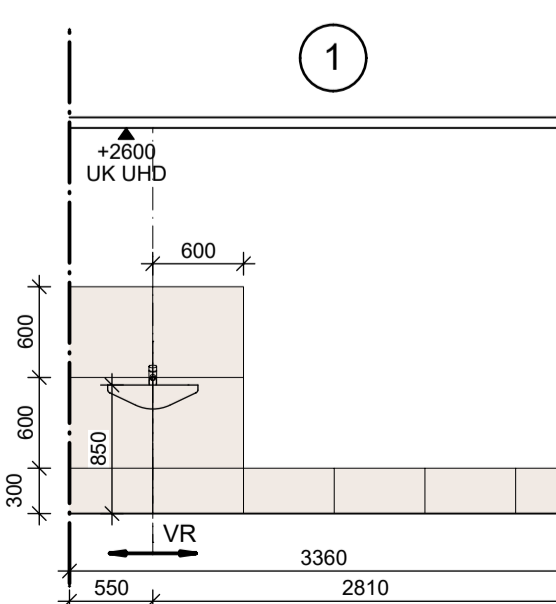

± 0.00 = +105.65 m über NN

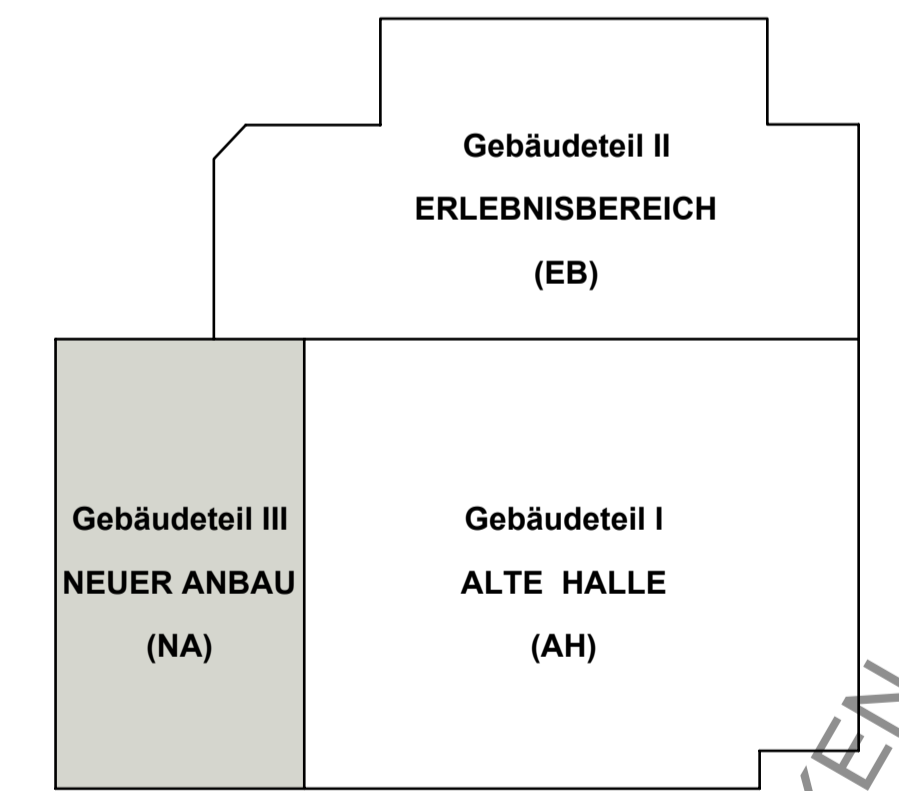

Index	Datum	Änderung	Name	geprüft
c				
b				
a				

Bauherr:	Stadt Senftenberg	Datum:	20.01.2026
Projekt:	Sanierung Erlebnisbad Senftenberg	Projektnummer:	gezeichnet
Teilobjekt:	Gebäudeteil III - Neuer Anbau	24 05	bearbeitet
Darstellung:	Wandabwicklungen	Leistungsphase:	geprüft
	Neuer Anbau	Zeichn.-Nr.:	ARC_3600_NA_FS
Maßstab:	1 : 50	Blattgröße:	1070 x 650