

Deutsches Museum

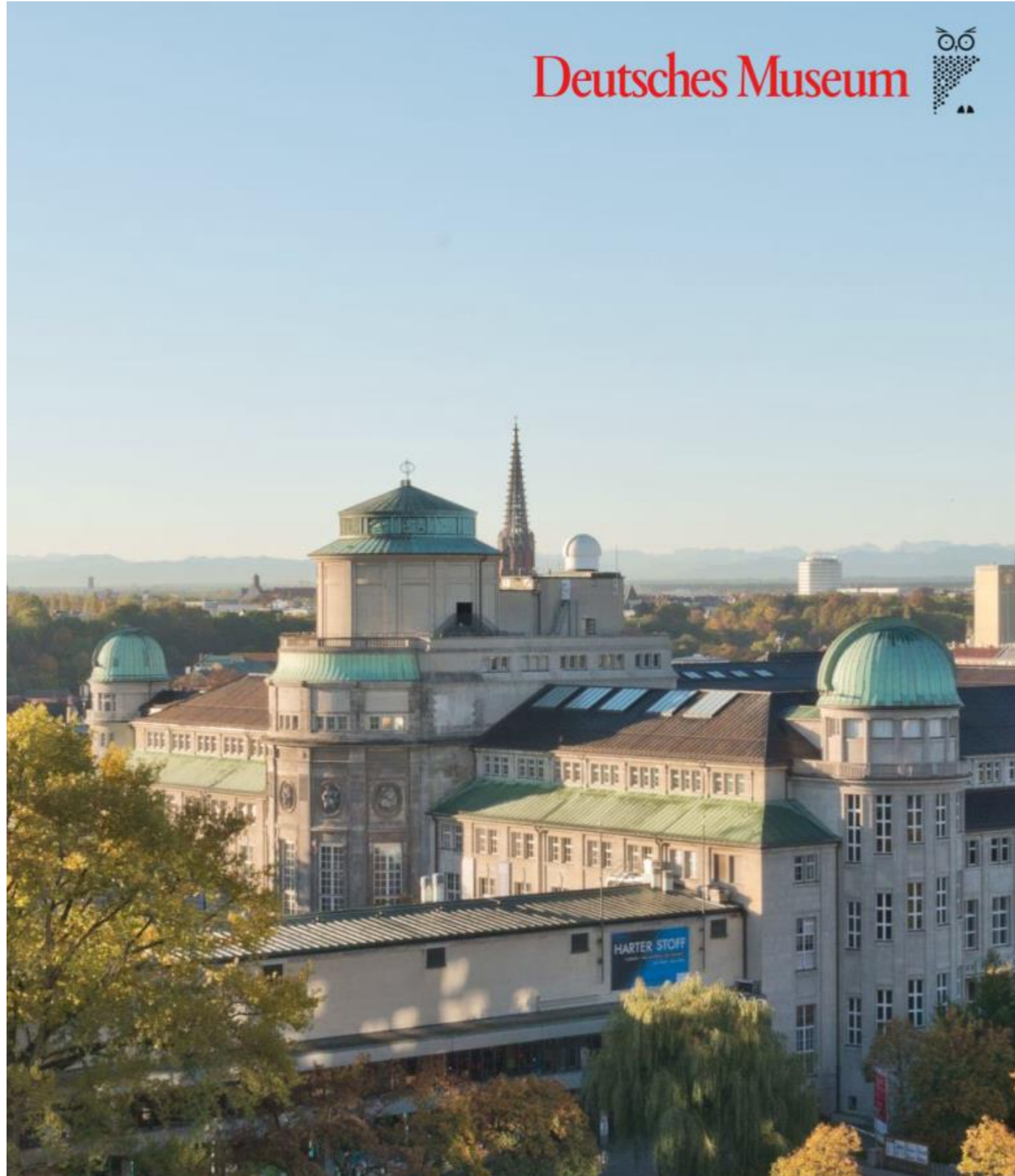

# Sanierung Sammlungsbau

## Entwurf RA 2

### Übersichten Lastannahmen Verkehrslasten

Stand: 28.03.2022

6.OG / ZG

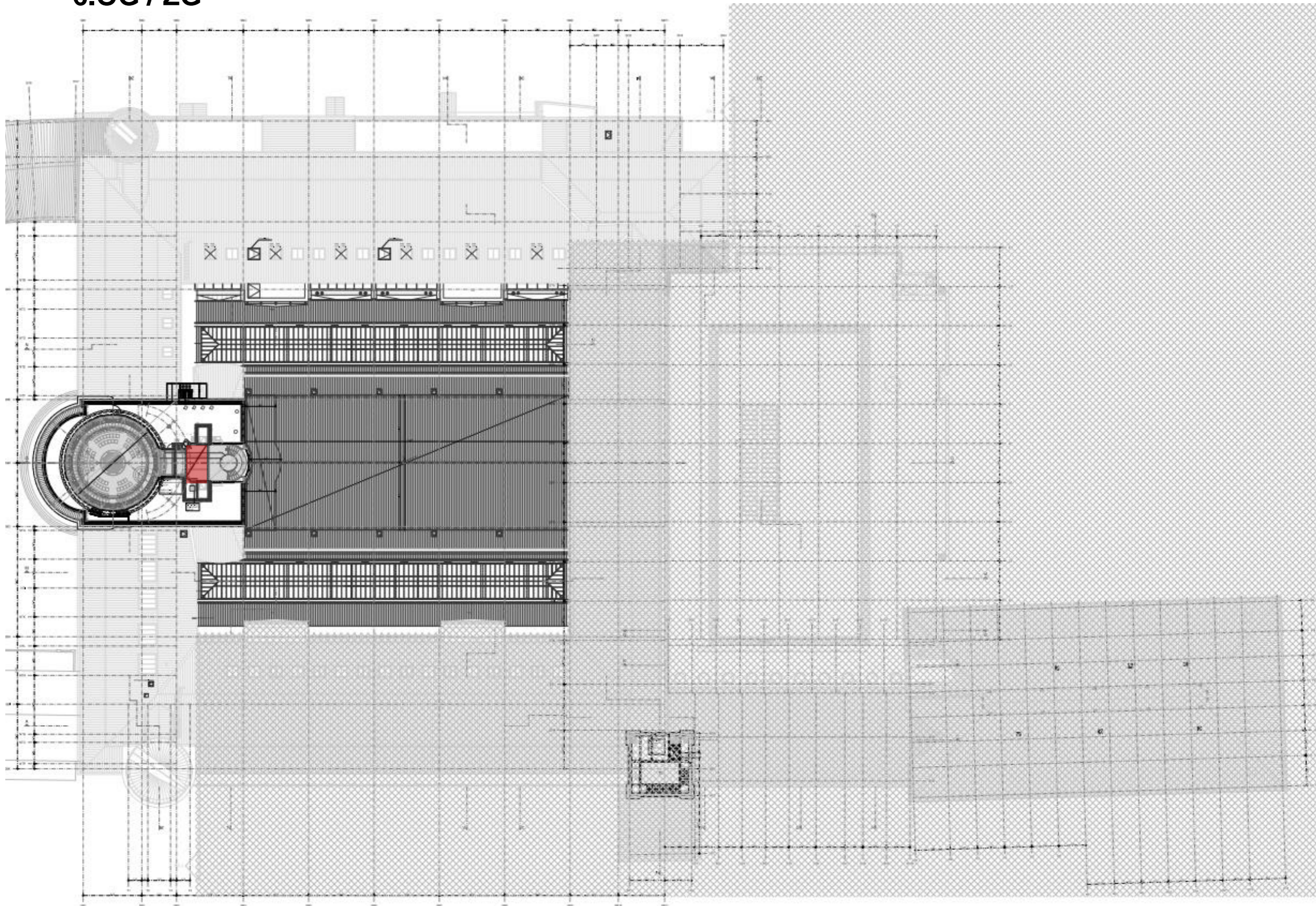

Lastannahme Verkehrslast:

-  2,0 kN/m<sup>2</sup>
-  3,5 kN/m<sup>2</sup>
-  5,0 kN/m<sup>2</sup>
-  10,0 kN/m<sup>2</sup>
-  15 kN/m<sup>2</sup>
-  keine Angaben

### 6. OG

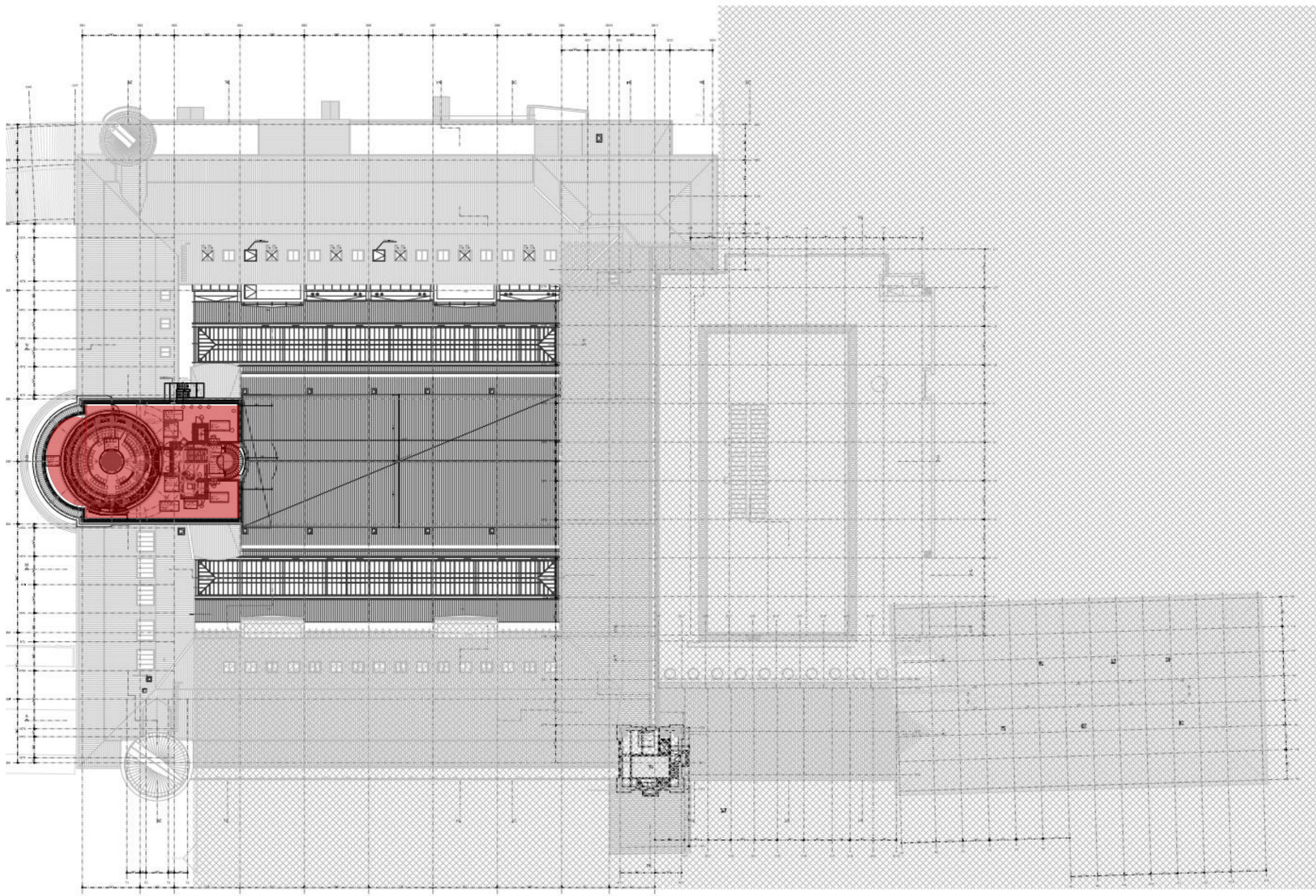

#### Lastannahme Verkehrslast:

-  2,0 kN/m<sup>2</sup>
-  3,5 kN/m<sup>2</sup>
-  5,0 kN/m<sup>2</sup>
-  10,0 kN/m<sup>2</sup>
-  15 kN/m<sup>2</sup>
-  keine Angaben

### 5. OG

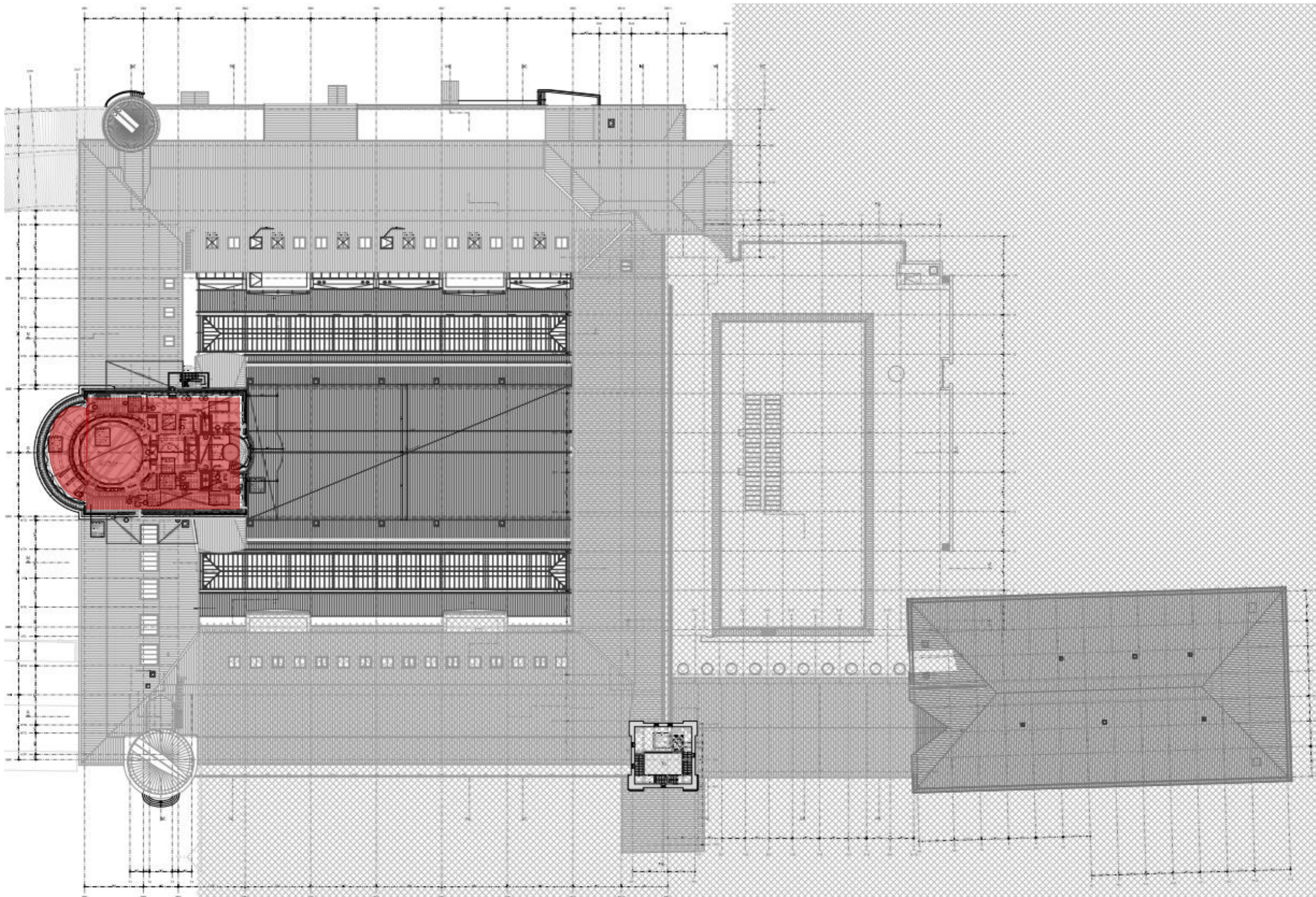

Lastannahme Verkehrslast:

-  2,0 kN/m<sup>2</sup>
-  3,5 kN/m<sup>2</sup>
-  5,0 kN/m<sup>2</sup>
-  10,0 kN/m<sup>2</sup>
-  15 kN/m<sup>2</sup>
-  keine Angaben

### 4. OG

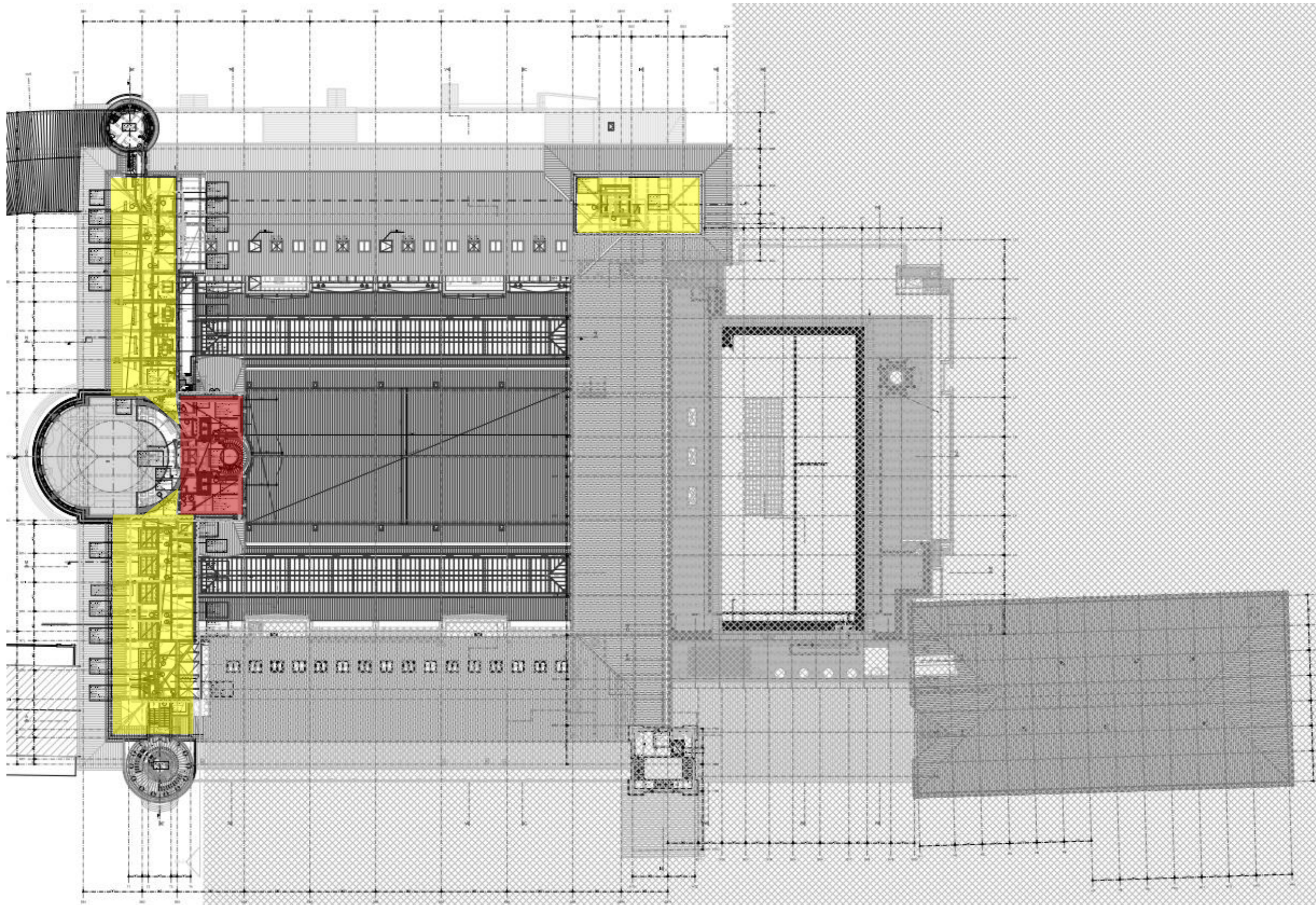

Lastannahme Verkehrslast:

-  2,0 kN/m<sup>2</sup>
-  3,5 kN/m<sup>2</sup>
-  5,0 kN/m<sup>2</sup>
-  10,0 kN/m<sup>2</sup>
-  15 kN/m<sup>2</sup>
-  keine Angaben

### 3. OG / ZG

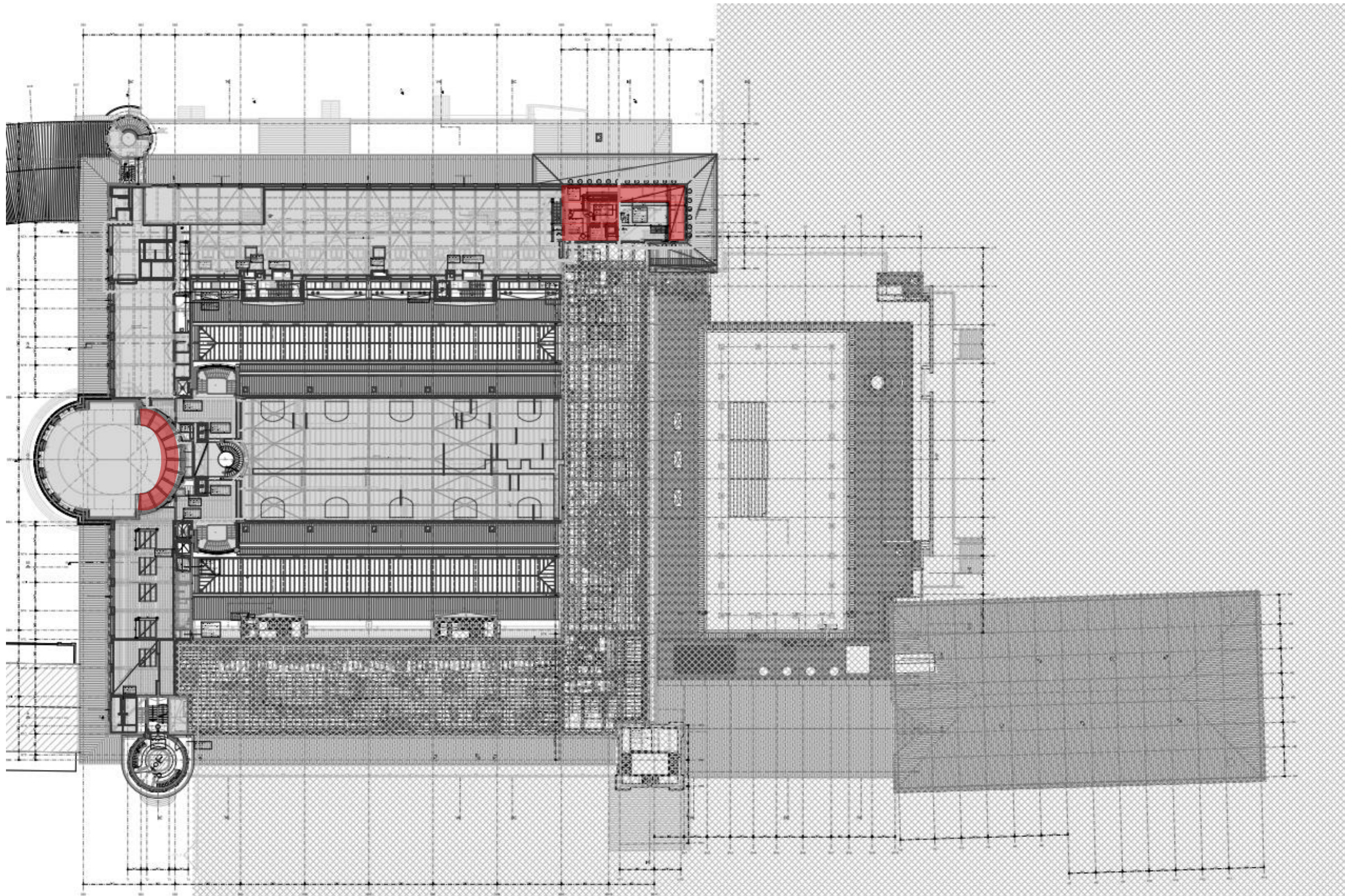

Lastannahme Verkehrslast:

-  2,0 kN/m<sup>2</sup>
-  3,5 kN/m<sup>2</sup>
-  5,0 kN/m<sup>2</sup>
-  10,0 kN/m<sup>2</sup>
-  15 kN/m<sup>2</sup>
-  keine Angaben

### 3. OG

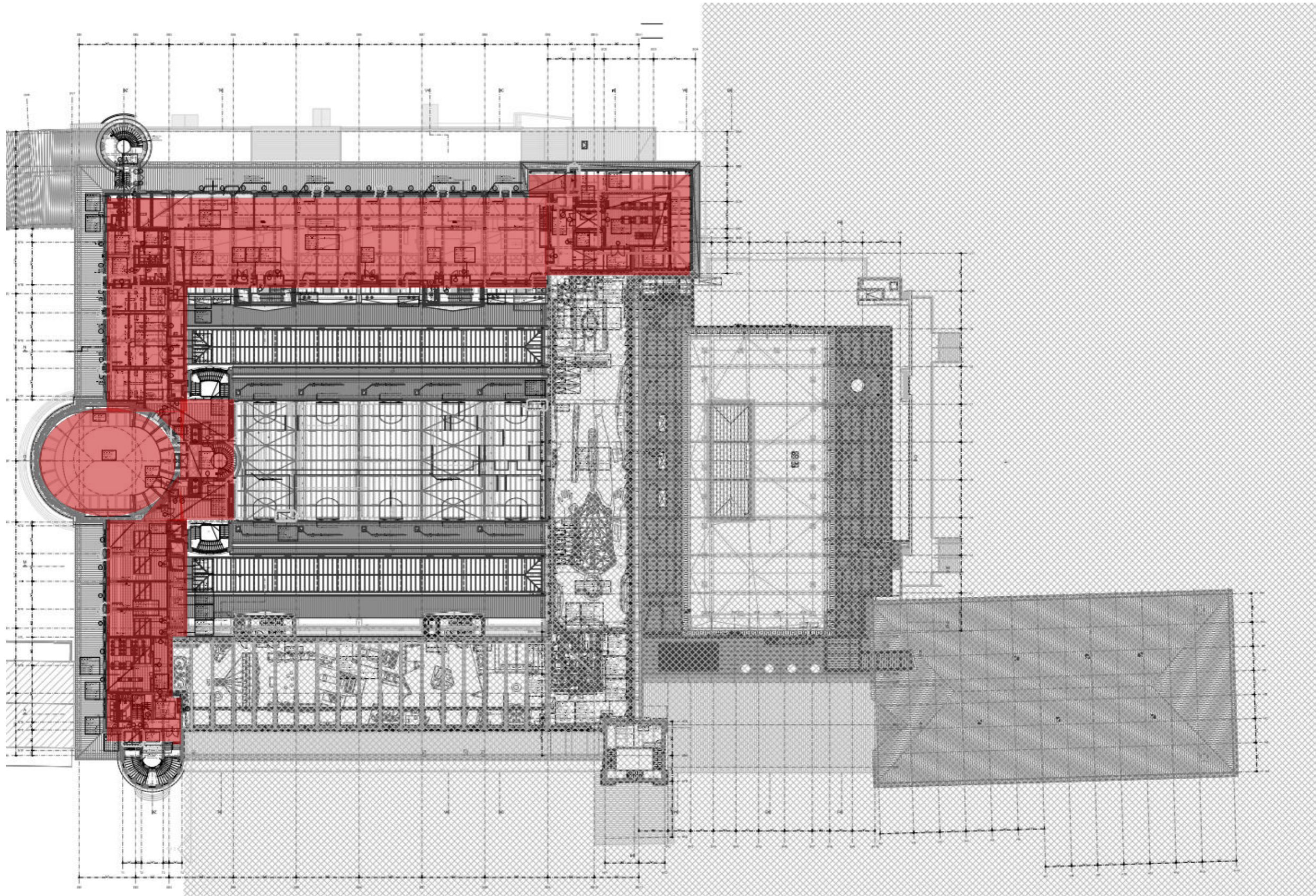

#### Lastannahme Verkehrslast:

-  2,0 kN/m<sup>2</sup>
-  3,5 kN/m<sup>2</sup>
-  5,0 kN/m<sup>2</sup>
-  10,0 kN/m<sup>2</sup>
-  15 kN/m<sup>2</sup>
-  keine Angaben

### 2. OG

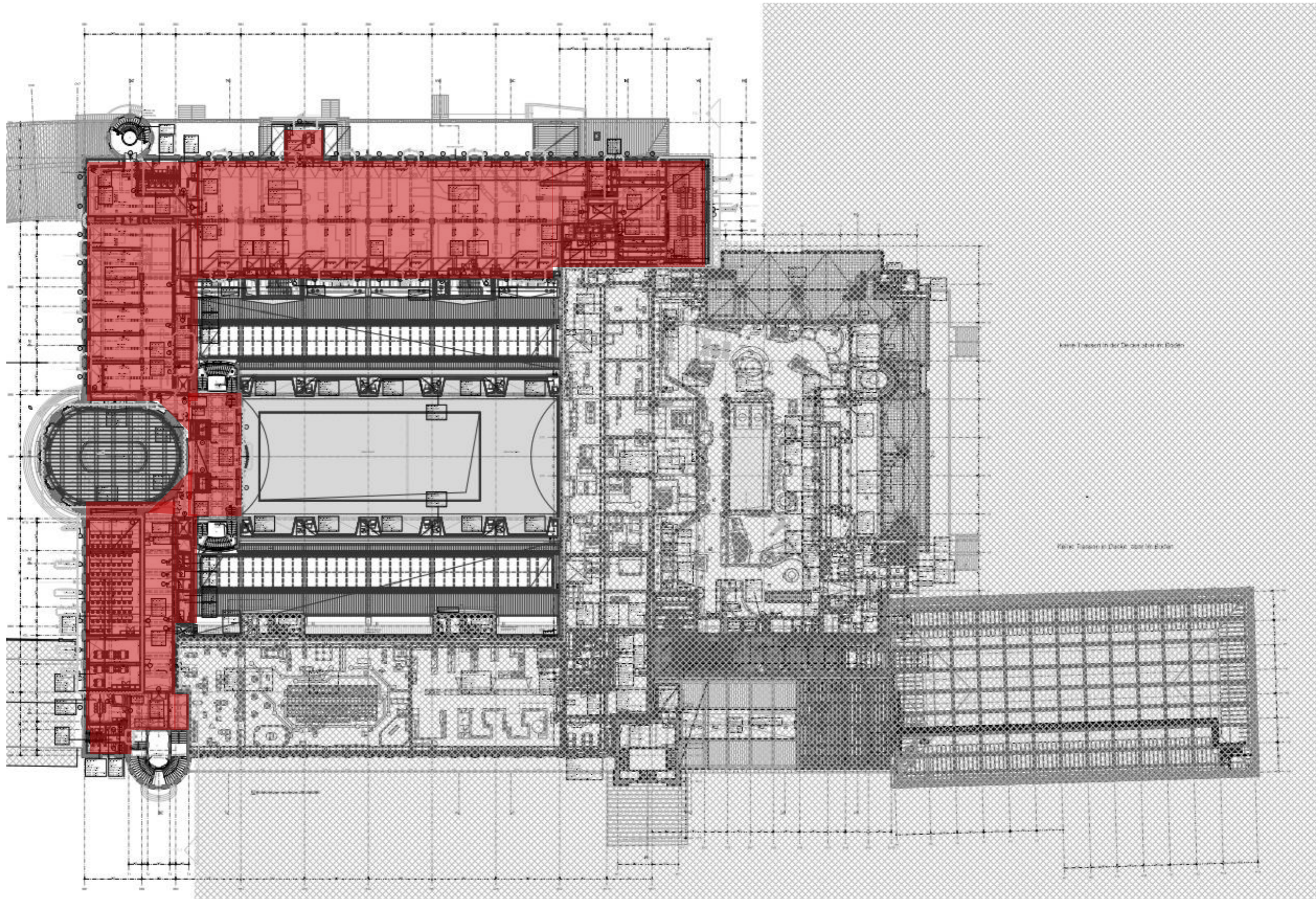



#### Lastannahme Verkehrslast:

-  2,0 kN/m<sup>2</sup>
-  3,5 kN/m<sup>2</sup>
-  5,0 kN/m<sup>2</sup>
-  10,0 kN/m<sup>2</sup>
-  15 kN/m<sup>2</sup>
-  keine Angaben

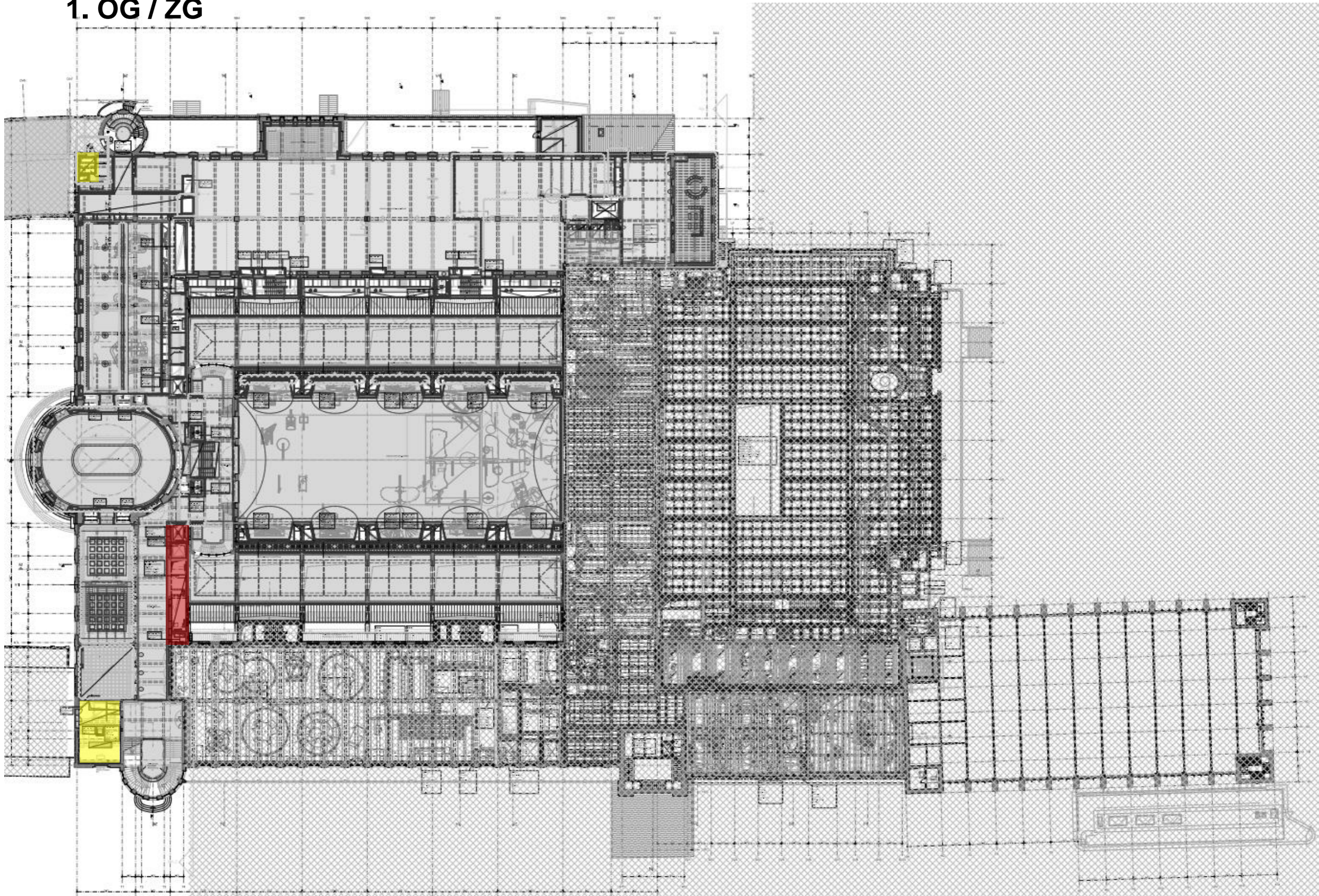
1. OG / ZG



Lastannahme Verkehrslast:

-  2,0 kN/m<sup>2</sup>
-  3,5 kN/m<sup>2</sup>
-  5,0 kN/m<sup>2</sup>
-  10,0 kN/m<sup>2</sup>
-  15 kN/m<sup>2</sup>
-  keine Angaben

1. OG

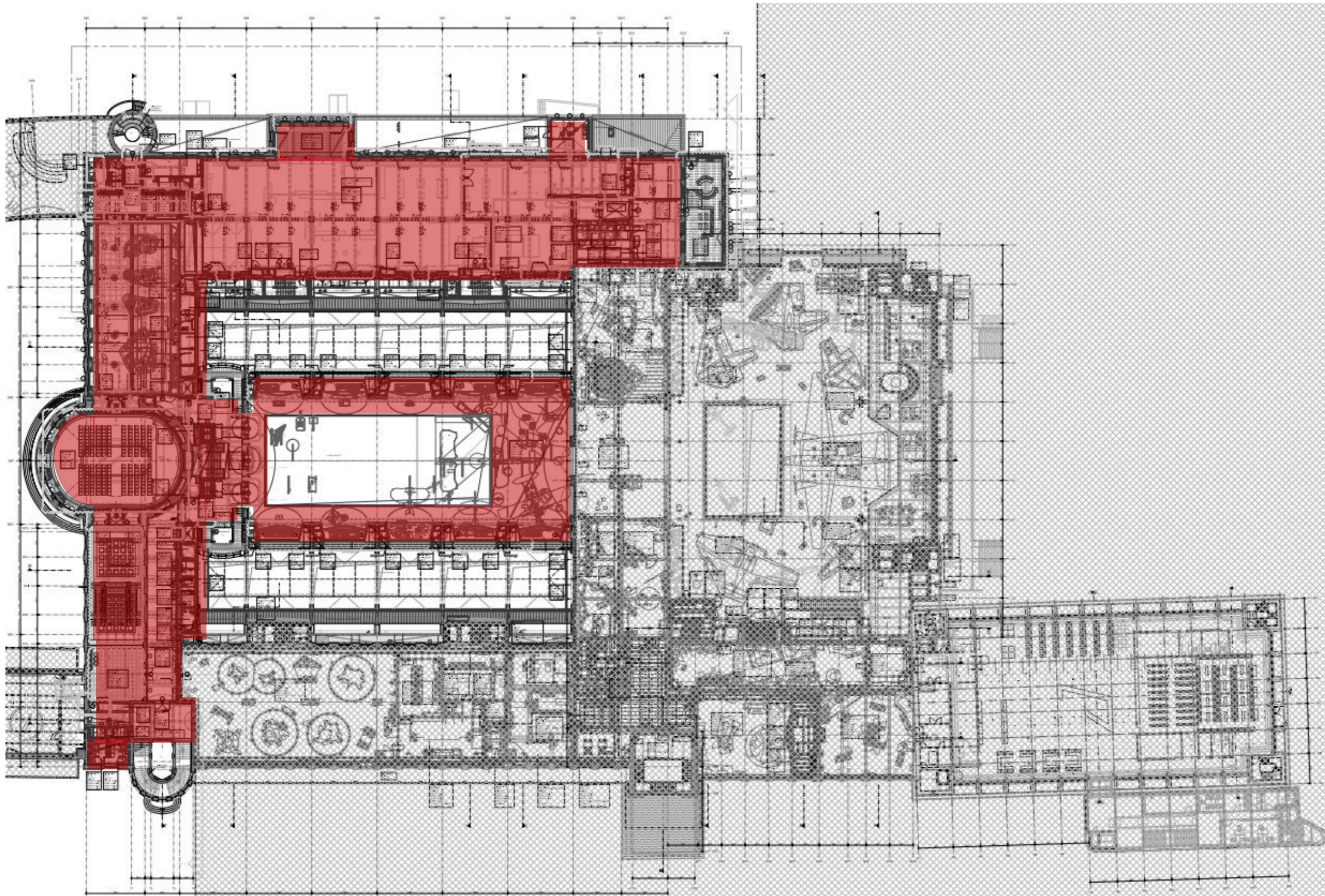

Lastannahme Verkehrslast:

-  2,0 kN/m<sup>2</sup>
-  3,5 kN/m<sup>2</sup>
-  5,0 kN/m<sup>2</sup>
-  10,0 kN/m<sup>2</sup>
-  15 kN/m<sup>2</sup>
-  keine Angaben

EG / ZG

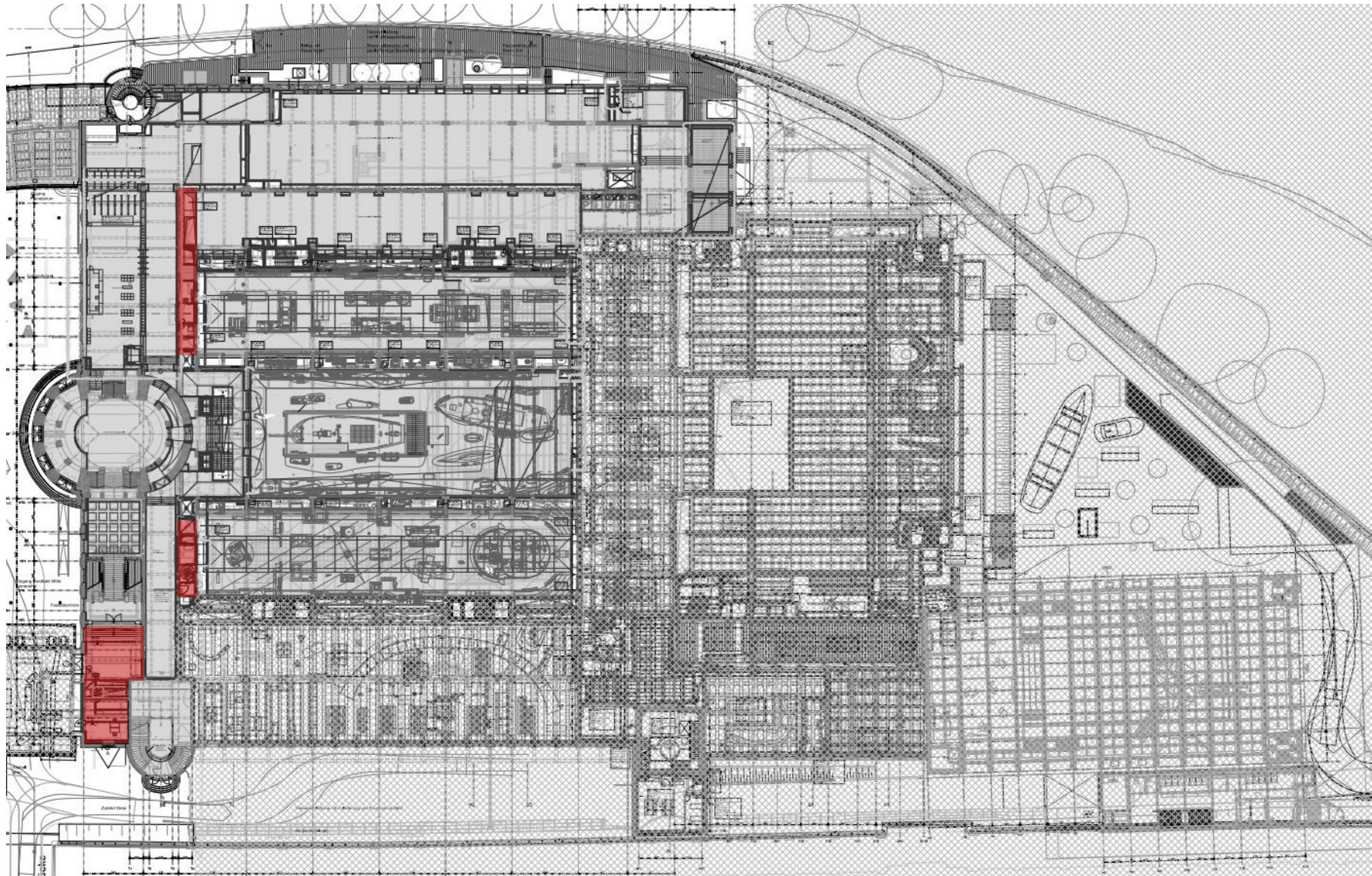





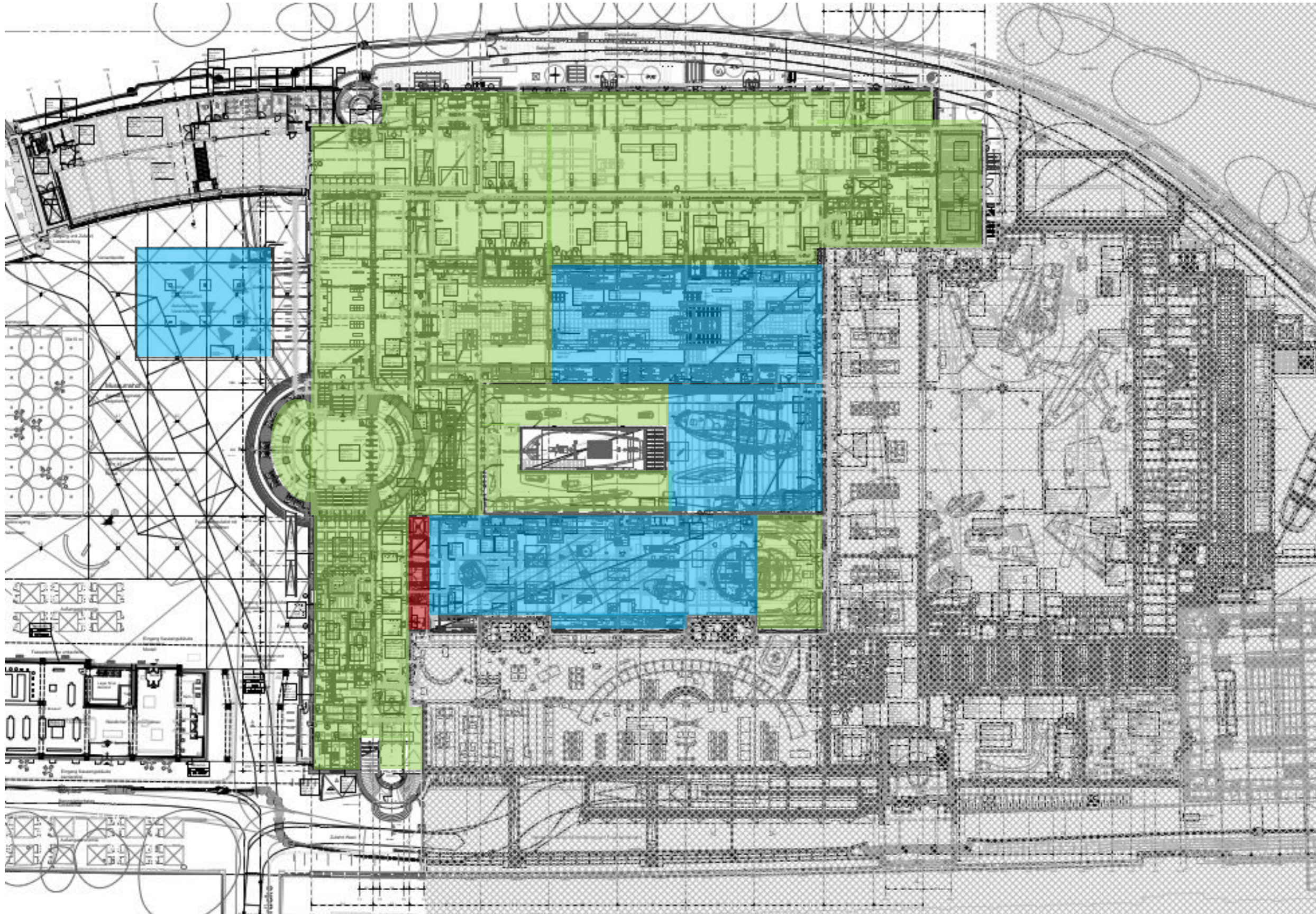

Lastannahme Verkehrslast:

-  2,0 kN/m<sup>2</sup>
-  3,5 kN/m<sup>2</sup>
-  5,0 kN/m<sup>2</sup>
-  10,0 kN/m<sup>2</sup>
-  15 kN/m<sup>2</sup>
-  keine Angaben

EG



Lastannahme Verkehrslast:

	2,0 kN/m <sup>2</sup>
	3,5 kN/m <sup>2</sup>
	5,0 kN/m <sup>2</sup>
	10,0 kN/m <sup>2</sup>
	15 kN/m <sup>2</sup>
	keine Angaben

1.UG

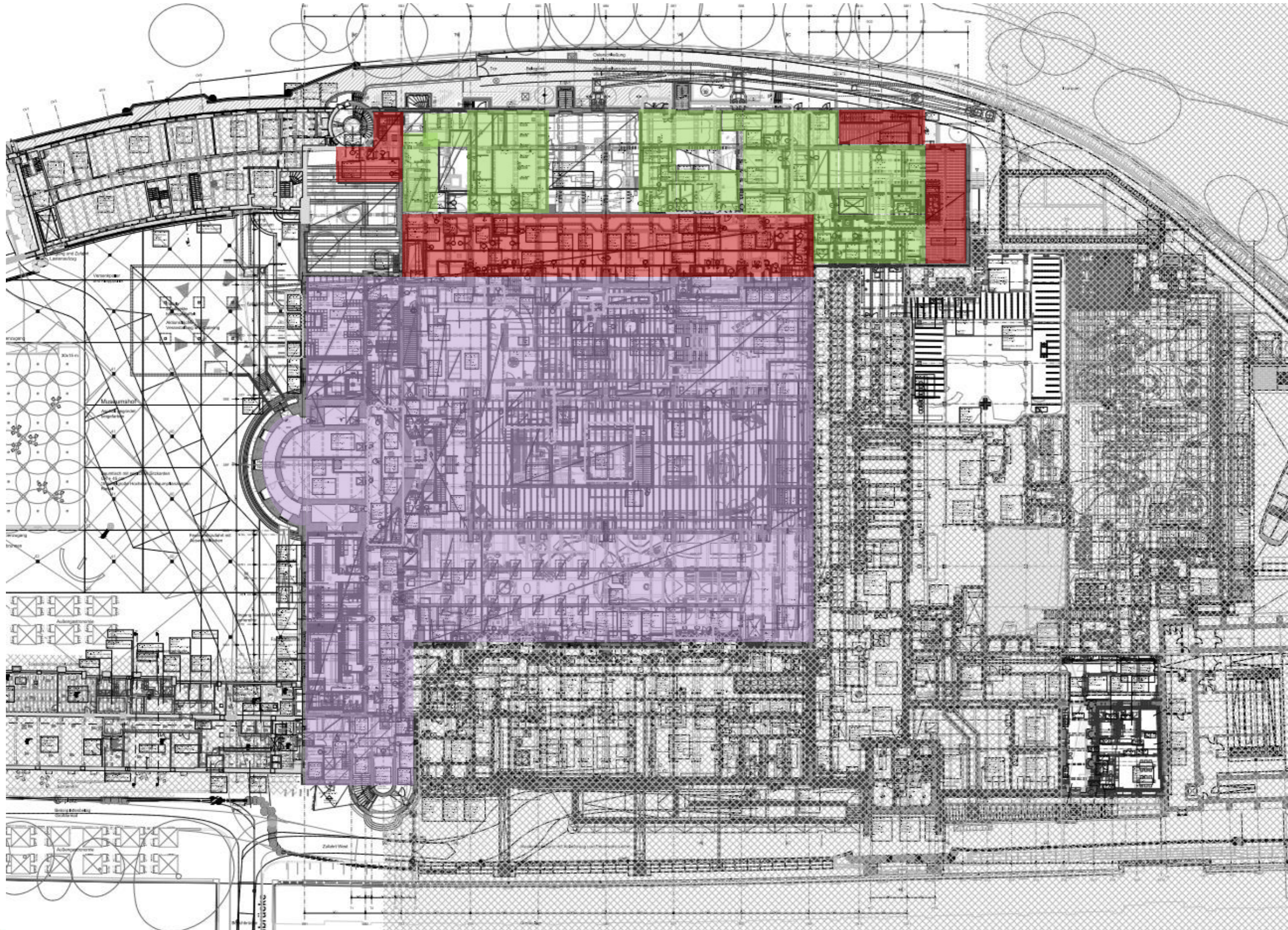

Lastannahme Verkehrslast:

-  2,0 kN/m<sup>2</sup>
-  3,5 kN/m<sup>2</sup>
-  5,0 kN/m<sup>2</sup>
-  10,0 kN/m<sup>2</sup>
-  15 kN/m<sup>2</sup>
-  keine Angaben  
(nichttragende  
Bodenplatte)

2.UG

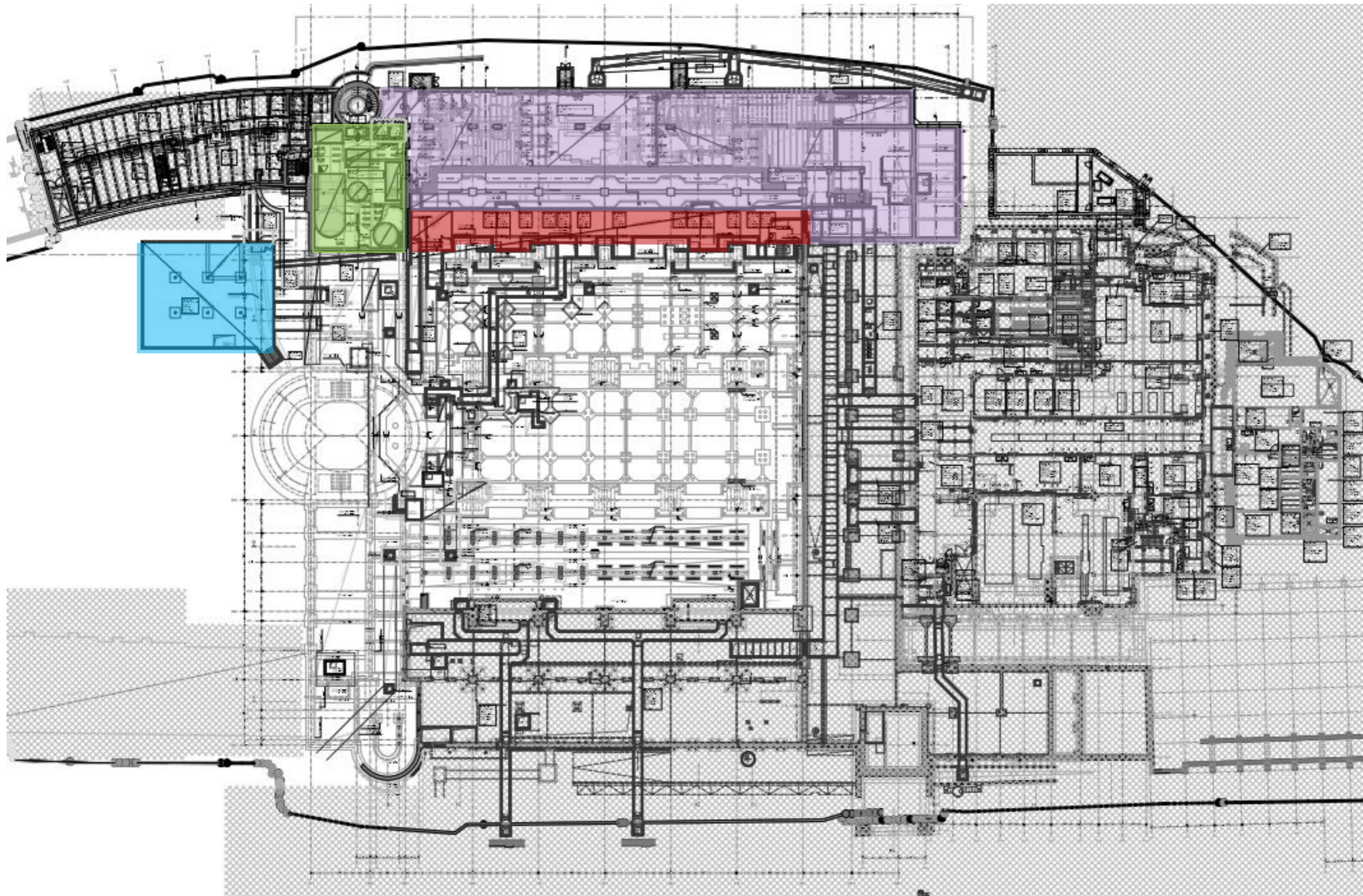

Lastannahme Verkehrslast:

-  2,0 kN/m<sup>2</sup>
-  3,5 kN/m<sup>2</sup>
-  5,0 kN/m<sup>2</sup>
-  10,0 kN/m<sup>2</sup>
-  15 kN/m<sup>2</sup>
-  keine Angaben  
(nichttragende  
Bodenplatte)