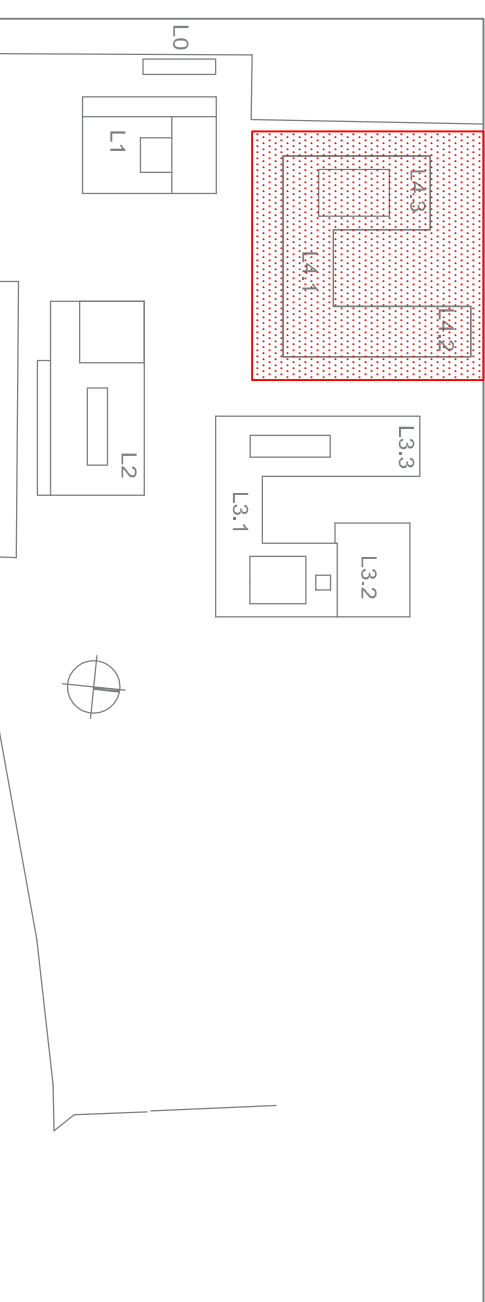
[illegible]

Pumps	Volumen/ton	Förderhöhe	T ₃₀
P1	6,4 m ³ /h	9,63m	IP-2 32/50/6-1/2-2-R
P2	5,3 m ³ /h	7,16m	IP-4 32/110/0-75/2-2-R
P3	4,6 m ³ /h	6,49m	Stratos 4,0/1-0 CAN PQ 6/70
P4	4,6 m ³ /h	2,71m	Tops 5,0/4-1 PQ 6/70
P5	0,337 m ³ /h	2,21m	Stratos P10 5/1-4 130
P6	2,4 m ³ /h	2,2m	Tops 30/5-5 PQ 10

Datum:	Beschreibung:	geprüft:	Vermessung:	Inhalt:
				A
				B
				C
				D
				E
				F
				G
				H
				I
				J
				K
				L
				M
				N
				O
				P
				Q
				R
				S
				T
				U
				V
				W
				X
				Y
				Z

[illegible]